

Ball valves 2-way

Ball valve type 546 PVC-U With mounting inserts With solvent cement sockets metric

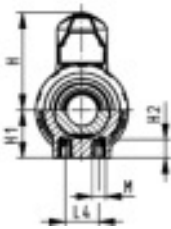

DN10-50

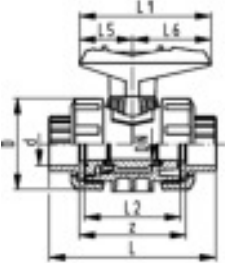

Model:

- For easy installation and removal
- Ball seals PTFE
- Integrated stainless steel mounting inserts
- Image and drawing DN65-100 please see **"New product ball valve DN65-100"**
- z-dimension, valve end and valve nut are **not compatible** with type 346 (DN10/15-50) resp. type 370 (DN65-100)

Option:

- Individual configuration of the valve (see form)
- Multifunctional module with integrated limit switches
- Pneumatic or electric actuators from +GF+

d [mm]	DN [mm]	PN	kv-value ($\Delta p=1$ bar) [l/min]	EPDM Code	FPM Code	GP	kg
16	10	16	71	161 546 061	161 546 071	10	0.150
20	15	16	185	161 546 062	161 546 072	10	0.150
25	20	16	350	161 546 063	161 546 073	10	0.230
32	25	16	700	161 546 064	161 546 074	10	0.330
40	32	16	1000	161 546 065	161 546 075	6	0.600
50	40	16	1600	161 546 066	161 546 076	6	0.800
63	50	16	3100	161 546 067	161 546 077	4	1.460
75	65	16	5000	161 546 068	161 546 078	-	4.900
90	80	16	7000	161 546 069	161 546 079	-	7.400
110	100	16	11000	161 546 070	161 546 080	-	11.600

d [mm]	D [mm]	H [mm]	H1 [mm]	H2 [mm]	L [mm]	L1 [mm]	L2 [mm]	L4 [mm]	L5 [mm]	L6 [mm]	M	z [mm]
16	50	57	27	12	92	77	56	25	32	45	6	64
20	50	57	27	12	95	77	56	25	32	45	6	64
25	58	67	30	12	110	97	65	25	39	58	6	72
32	68	73	36	12	123	97	71	25	39	58	6	79
40	84	90	44	15	146	128	85	45	54	74	8	94
50	97	97	51	15	157	128	89	45	54	74	8	95
63	124	116	64	15	183	152	101	45	66	87	8	107
75	166	149	85	15	233	270	136	70	64	206	8	144
90	200	161	105	15	254	270	141	70	64	206	8	151
110	238	178	123	22	301	320	164	120	64	256	12	174

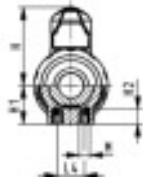
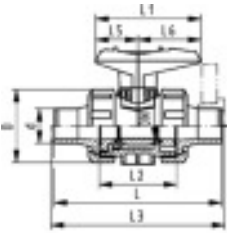

Ball valve type 546 PVC-U With mounting inserts With solvent cement spigots metric

Model:

- For easy installation and removal
- Ball seals PTFE
- Integrated stainless steel mounting inserts
- Image and drawing DN65-100 please see **"New product ball valve DN65-100"**
- z-dimension, valve end and valve nut are **not compatible** with type 346 (DN10/15-50) resp. type 370 (DN65-100)

Option:

- Individual configuration of the valve (see form)
- Multifunctional module with integrated limit switches
- Pneumatic or electric actuators from +GF+

d [mm]	DN [mm]	PN	kv-value ($\Delta p=1$ bar) [l/min]	EPDM Code	FPM Code	GP	kg
16	10	16	71	161 546 721	161 546 731	10	0.157
20	15	16	185	161 546 722	161 546 732	10	0.157
25	20	16	350	161 546 723	161 546 733	10	0.242
32	25	16	700	161 546 724	161 546 734	10	0.347
40	32	16	1000	161 546 725	161 546 735	6	0.620
50	40	16	1600	161 546 726	161 546 736	6	0.845
63	50	16	3100	161 546 727	161 546 737	4	1.550
75	65	16	5000	161 546 728	161 546 738	-	5.100
90	80	16	7000	161 546 729	161 546 739	-	7.500
110	100	16	11000	161 546 730	161 546 740	-	11.900

d [mm]	D [mm]	H [mm]	H1 [mm]	H2 [mm]	L [mm]	L1 [mm]	L2 [mm]	L3 [mm]	L4 [mm]	L5 [mm]	L6 [mm]	M
16	50	57	27	12	114	77	56	130	25	32	45	M6
20	50	57	27	12	124	77	56	130	25	32	45	M6
25	58	67	30	12	144	97	65	150	25	39	58	M6
32	68	73	36	12	154	97	71	160	25	39	58	M6
40	84	90	44	15	174	128	85	180	45	54	74	M8
50	97	97	51	15	194	128	89	200	45	54	74	M8
63	124	116	64	15	224	152	101	230	45	66	87	M8
75	166	149	85	15	284	270	136	290	70	64	206	M8
90	200	161	105	15	300	270	141	310	70	64	206	M8
110	238	178	123	22	340	320	164	350	120	64	256	M12



DN10-50

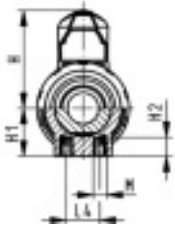
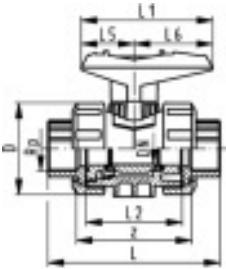

Ball valve type 546 PVC-U With mounting inserts With threaded sockets Rp

Model:

- For easy installation and removal
- Ball seals PTFE
- Integrated stainless steel mounting inserts
- Image and drawing DN65-100 please see **"New product ball valve DN65-100"**
- z-dimension, valve end and valve nut are **not compatible** with type 346 (DN10/15-50) resp. type 370 (DN65-100)

Option:

- Individual configuration of the valve (see form)
- Multifunctional module with integrated limit switches
- Pneumatic or electric actuators from +GF+

Rp [inch]	DN [mm]	PN	kv-value ($\Delta p=1$ bar) [l/min]	EPDM Code	FPM Code	GP	kg
3/8	10	10	71	161 546 741	161 546 751	10	0.152
1/2	15	10	185	161 546 742	161 546 752	10	0.152
3/4	20	10	350	161 546 743	161 546 753	10	0.232
1	25	10	700	161 546 744	161 546 754	10	0.332
1 1/4	32	10	1000	161 546 745	161 546 755	6	0.605
1 1/2	40	10	1600	161 546 746	161 546 756	6	0.805
2	50	10	3100	161 546 747	161 546 757	4	1.465
2 1/2	65	10	5000	161 546 748	161 546 758	-	5.000
3	80	10	7000	161 546 749	161 546 759	-	7.500
4	100	10	11000	161 546 750	161 546 760	-	11.700

Rp [inch]	D [mm]	H [mm]	H1 [mm]	H2 [mm]	L [mm]	L1 [mm]	L2 [mm]	L4 [mm]	L5 [mm]	L6 [mm]	M	z [mm]
3/8	50	57	27	12	95	77	56	25	32	45	M6	69
1/2	50	57	27	12	100	77	56	25	32	45	M6	67
3/4	58	67	30	12	114	97	65	25	39	58	M6	78
1	68	73	36	12	127	97	71	25	39	58	M6	85
1 1/4	84	90	44	15	146	128	85	45	54	74	M8	100
1 1/2	97	97	51	15	152	128	89	45	54	74	M8	106
2	124	116	64	15	177	152	101	45	66	87	M8	121
2 1/2	166	149	85	15	233	270	136	70	64	206	M8	144
3	200	161	105	15	254	270	141	70	64	206	M8	151
4	238	178	123	22	301	320	164	120	64	256	M12	174



DN10/15 - 50

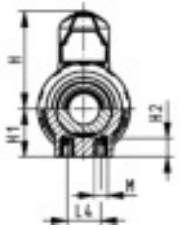
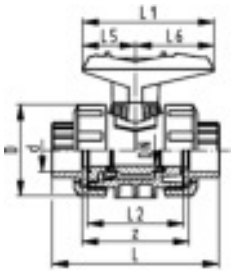

Ball valve type 546 PVC-U With mounting inserts With fusion sockets PE100 metric

Model:

- For easy installation and removal
- Ball seals PTFE
- Integrated stainless steel mounting inserts
- z-dimension, valve end and valve nut are not compatible with type 346

Option:

- Individual configuration of the valve (see form)
- Multifunctional module with integrated limit switches
- Pneumatic or electric actuators from +GF+

d [mm]	DN [mm]	PN	kv-value ($\Delta p=1$ bar) [l/min]	EPDM Code	FPM Code	kg
16	10	16	71	161 546 761	161 546 771	0.150
20	15	16	185	161 546 762	161 546 772	0.150
25	20	16	350	161 546 763	161 546 773	0.220
32	25	16	700	161 546 764	161 546 774	0.310
40	32	16	1000	161 546 765	161 546 775	0.550
50	40	16	1600	161 546 766	161 546 776	0.750
63	50	16	3100	161 546 767	161 546 777	1.360

d [mm]	D [mm]	H [mm]	H1 [mm]	H2 [mm]	L [mm]	L1 [mm]	L2 [mm]	L4 [mm]	L5 [mm]	L6 [mm]	M	z [mm]
16	50	57	27	12	93	77	56	25	32	45	M6	67
20	50	57	27	12	95	77	56	25	32	45	M6	66
25	58	67	30	12	108	97	65	25	39	58	M6	77
32	68	73	36	12	119	97	71	25	39	58	M6	83
40	84	90	44	15	137	128	85	45	54	74	M8	99
50	97	97	51	15	147	128	89	45	54	74	M8	105
63	124	116	64	15	168	152	101	45	66	87	M8	113



DN10/15 - 50

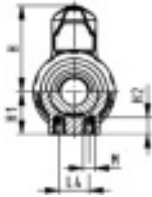
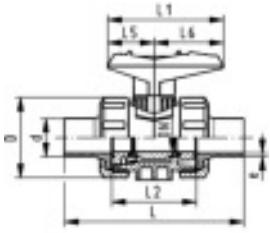

Ball valve type 546 PVC-U With mounting inserts With butt fusion spigots PE100 SDR11 metric

Model:

- For easy installation and removal
- Ball seals PTFE
- Integrated stainless steel mounting inserts
- z-dimension, valve end and valve nut are not compatible with type 346

Option:

- Individual configuration of the valve (see form)
- Multifunctional module with integrated limit switches
- Pneumatic or electric actuators from +GF+

d [mm]	DN [mm]	PN	kv-value ($\Delta p=1$ bar) [l/min]	EPDM Code	FPM Code	kg
20	15	16	185	161 546 782	161 546 792	0.150
25	20	16	350	161 546 783	161 546 793	0.220
32	25	16	700	161 546 784	161 546 794	0.310
40	32	16	1000	161 546 785	161 546 795	0.550
50	40	16	1600	161 546 786	161 546 796	0.750
63	50	16	3100	161 546 787	161 546 797	1.360

d [mm]	D [mm]	H [mm]	H1 [mm]	H2 [mm]	L [mm]	L1 [mm]	L2 [mm]	L4 [mm]	L5 [mm]	L6 [mm]	M	e [mm]
20	50	57	27	12	130	77	56	25	32	45	M6	1,9
25	58	67	30	12	134	97	65	25	39	58	M6	2,3
32	68	73	36	12	150	97	71	25	39	58	M6	3
40	84	90	44	15	171	128	85	45	54	74	M8	3,7
50	97	97	51	15	191	128	89	45	54	74	M8	4,6
63	124	116	64	15	220	152	101	45	66	87	M8	5,8



DN10/15 - 50

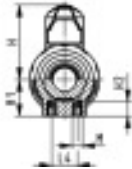
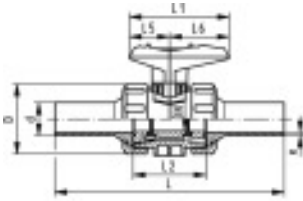



Ball valve type 546 PVC-U With mounting inserts With butt fusion spigots long PE100 SDR11 metric



Model:

- For easy installation and removal
- Ball seals PTFE
- Integrated stainless steel mounting inserts
- Image and drawing DN65-100 please see **"New product ball valve DN65-100"**
- z-dimension, valve end and valve nut are **not compatible** with type 346 (DN10/15-50) resp. type 370 (DN65-100)

Option:

- Individual configuration of the valve (see form)
- Multifunctional module with integrated limit switches
- Pneumatic or electric actuators from +GF+

d [mm]	DN [mm]	PN	kv-value ($\Delta p=1$ bar) [l/min]	EPDM Code	FPM Code	kg
20	15	16	185	161 546 822	161 546 832	0.150
25	20	16	350	161 546 823	161 546 833	0.220
32	25	16	700	161 546 824	161 546 834	0.310
40	32	16	1000	161 546 825	161 546 835	0.550
50	40	16	1600	161 546 826	161 546 836	0.750
63	50	16	3100	161 546 827	161 546 837	1.360
 75	65	16	5000	161 546 828	161 546 838	5.000
 90	80	16	7000	161 546 829	161 546 839	7.500
 110	100	16	11000	161 546 830	161 546 840	11.800

d [mm]	D [mm]	H [mm]	H1 [mm]	H2 [mm]	L [mm]	L1 [mm]	L2 [mm]	L4 [mm]	L5 [mm]	L6 [mm]	M	e [mm]
20	50	57	27	12	193	77	56	25	32	45	M6	2,3
25	58	67	30	12	216	97	65	25	39	58	M6	2,3
32	68	73	36	12	223	97	71	25	39	58	M6	3
40	84	90	44	15	249	128	85	45	54	74	M8	3,7
50	97	97	51	15	271	128	89	45	54	74	M8	4,6
63	124	116	64	15	321	152	101	45	66	87	M8	5,8
 75	166	149	85	15	386	270	136	70	64	206	M8	6,8
 90	200	161	105	15	421	270	141	70	64	206	M8	8,2
 110	238	178	123	22	484	320	164	120	64	256	M12	10



DN10/15 - 50

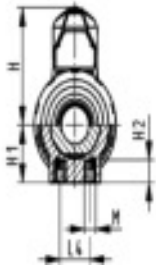
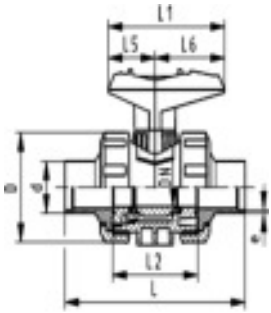

Ball valve type 546 PVC-U With mounting inserts With butt fusion spigots PE100 SDR17.6 metric

Model:

- For easy installation and removal
- Ball seals PTFE
- Integrated stainless steel mounting inserts
- z-dimension, valve end and valve nut are not compatible with type 346

Option:

- Individual configuration of the valve (see form)
- Multifunctional module with integrated limit switches
- Pneumatic or electric actuators from +GF+

d [mm]	DN [mm]	PN	kv-value ($\Delta p=1$ bar) [l/min]	EPDM Code	FPM Code	kg
40	32	10	1000	161 546 805	161 546 815	0.550
50	40	10	1600	161 546 806	161 546 816	0.750
63	50	10	3100	161 546 807	161 546 817	1.360

d [mm]	D [mm]	H [mm]	H1 [mm]	H2 [mm]	L [mm]	L1 [mm]	L2 [mm]	L4 [mm]	L5 [mm]	L6 [mm]	M	e [mm]
40	84	90	44	15	171	128	85	45	54	74	M8	2,3
50	97	97	51	15	191	128	89	45	54	74	M8	2,9
63	124	116	64	15	220	152	101	45	66	87	M8	3,6



DN10-50

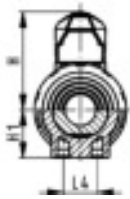
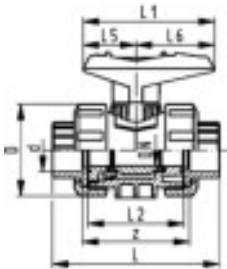



Ball valve type 546 PVC-U without mounting inserts With solvent cement sockets metric



Model:

- For easy installation and removal
- Ball seals PTFE
- Without mounting inserts
- Image and drawing DN65-100 please see **"New product ball valve DN65-100"**
- z-dimension, valve end and valve nut are **not compatible** with type 346 (DN10/15-50) resp. type 370 (DN65-100)

Option:

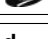
- Individual configuration of the valve (see form)
- Multifunctional module with integrated limit switches
- Pneumatic or electric actuators from +GF+

d [mm]	DN [mm]	PN	kv-value ($\Delta p=1$ bar) [l/min]	EPDM Code	FPM Code	GP	kg
16	10	16	71	161 546 001	161 546 011	10	0.150
20	15	16	185	161 546 002	161 546 012	10	0.150
25	20	16	350	161 546 003	161 546 013	10	0.230
32	25	16	700	161 546 004	161 546 014	10	0.330
40	32	16	1000	161 546 005	161 546 015	6	0.600
50	40	16	1600	161 546 006	161 546 016	6	0.800
63	50	16	3100	161 546 007	161 546 017	4	1.460
 75	65	16	5000	161 546 008	161 546 018	-	4.900
 90	80	16	7000	161 546 009	161 546 019	-	7.400
 110	100	16	11000	161 546 010	161 546 020	-	11.600

d [mm]	D [mm]	H [mm]	H1 [mm]	L [mm]	L1 [mm]	L2 [mm]	L4 [mm]	L5 [mm]	L6 [mm]	z [mm]
16	50	57	27	92	77	56	25	32	45	64
20	50	57	27	95	77	56	25	32	45	64
25	58	67	30	110	97	65	25	39	58	72
32	68	73	36	123	97	71	25	39	58	79
40	84	90	44	146	128	85	45	54	74	94
50	97	97	51	157	128	89	45	54	74	95
63	124	116	64	183	152	101	45	66	87	107
 75	166	149	85	233	270	136	70	64	206	144
 90	200	161	105	254	270	141	70	64	206	151
 110	238	178	123	301	320	164	120	64	256	174



Ball valve type 546 PVC-U without mounting inserts With solvent cement spigots metric



Model:

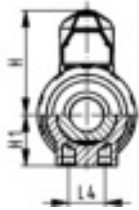
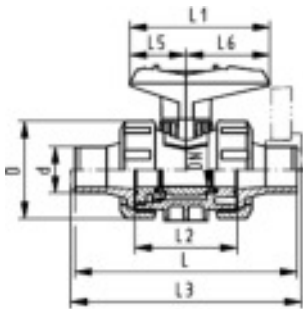

- For easy installation and removal
- Ball seals PTFE
- Without mounting inserts
- Image and drawing DN65-100 please see **"New product ball valve DN65-100"**
- z-dimension, valve end and valve nut are **not compatible** with type 346 (DN10/15-50) resp. type 370 (DN65-100)

Option:

- Individual configuration of the valve (see form)
- Multifunctional module with integrated limit switches
- Pneumatic or electric actuators from +GF+



d [mm]	DN [mm]	PN	kv-value ($\Delta p=1$ bar) [l/min]	EPDM Code	FPM Code	GP	kg
16	10	16	71	161 546 041	161 546 051	10	0.155
20	15	16	185	161 546 042	161 546 052	10	0.155
25	20	16	350	161 546 043	161 546 053	10	0.240
32	25	16	700	161 546 044	161 546 054	10	0.345
40	32	16	1000	161 546 045	161 546 055	6	0.615
50	40	16	1600	161 546 046	161 546 056	6	0.840
63	50	16	3100	161 546 047	161 546 057	4	1.545
 75	65	16	5000	161 546 048	161 546 058	-	5.100
 90	80	16	7000	161 546 049	161 546 059	-	7.500
 110	100	16	11000	161 546 050	161 546 060	-	11.900

d [mm]	D [mm]	H [mm]	H1 [mm]	L [mm]	L1 [mm]	L2 [mm]	L3 [mm]	L4 [mm]	L5 [mm]	L6 [mm]
16	50	57	27	114	77	56		25	32	45
20	50	57	27	124	77	56	130	25	32	45
25	58	67	30	144	97	65	150	25	39	58
32	68	73	36	154	97	71	160	25	39	58
40	84	90	44	174	128	85	180	45	54	74
50	97	97	51	194	128	89	200	45	54	74
63	124	116	64	224	152	101	230	45	66	87
 75	166	149	85	284	270	136	290	70	64	206
 90	200	161	105	300	270	141	310	70	64	206
 110	238	178	123	340	320	164	350	120	64	256



DN10-50

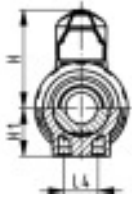
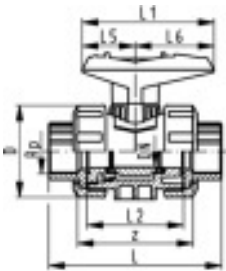



Ball valve type 546 PVC-U without mounting inserts With threaded sockets Rp



Model:

- For easy installation and removal
- Ball seals PTFE
- Without mounting inserts
- Image and drawing DN65-100 please see **"New product ball valve DN65-100"**
- z-dimension, valve end and valve nut are **not compatible** with type 346 (DN10/15-50) resp. type 370 (DN65-100)

Option:

- Individual configuration of the valve (see form)
- Multifunctional module with integrated limit switches
- Pneumatic or electric actuators from +GF+

Rp [inch]	DN [mm]	PN	kv-value ($\Delta p=1$ bar) [l/min]	EPDM Code	FPM Code	GP	kg
3/8	10	10	71	161 546 021	161 546 031	10	0.150
1/2	15	10	185	161 546 022	161 546 032	10	0.150
3/4	20	10	350	161 546 023	161 546 033	10	0.230
1	25	10	700	161 546 024	161 546 034	10	0.330
1 1/4	32	10	1000	161 546 025	161 546 035	6	0.600
1 1/2	40	10	1600	161 546 026	161 546 036	6	0.800
2	50	10	3100	161 546 027	161 546 037	4	1.460
 2 1/2	65	10	5000	161 546 028	161 546 038	-	5.000
 3	80	10	7000	161 546 029	161 546 039	-	7.500
 4	100	10	11000	161 546 030	161 546 040	-	11.700

Rp [inch]	D [mm]	H [mm]	H1 [mm]	L [mm]	L1 [mm]	L2 [mm]	L4 [mm]	L5 [mm]	L6 [mm]	z [mm]
3/8	50	57	27	95	77	56	25	32	45	69
1/2	50	57	27	100	77	56	25	32	45	67
3/4	58	67	30	114	97	65	25	39	58	78
1	68	73	36	127	97	71	25	39	58	85
1 1/4	84	90	44	146	128	85	45	54	74	100
1 1/2	97	97	51	152	128	89	45	54	74	106
2	124	116	64	177	152	101	45	66	87	121
 2 1/2	166	149	85	233	270	136	70	64	206	144
 3	200	161	105	254	270	141	70	64	206	151
 4	238	178	123	301	320	164	120	64	256	174



DN10/15 - 50

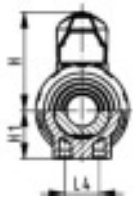
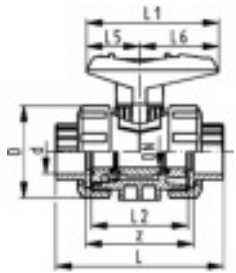

Ball valve type 546 PVC-U without mounting inserts With fusion sockets PE100 metric

Model:

- For easy installation and removal
- Ball seals PTFE
- Without mounting inserts
- z-dimension, valve end and valve nut are not compatible with type 346

Option:

- Individual configuration of the valve (see form)
- Multifunctional module with integrated limit switches
- Pneumatic or electric actuators from +GF+

d [mm]	DN [mm]	PN	kv-value ($\Delta p=1$ bar) [l/min]	EPDM Code	FPM Code	GP	kg
16	10	16	71	800 000 101	800 000 111	-	0.170
20	15	16	185	800 000 102	800 000 112	-	0.170
25	20	16	350	800 000 103	800 000 113	-	0.240
32	25	16	700	800 000 104	800 000 114	-	0.340
40	32	16	1000	800 000 105	800 000 115	-	0.610
50	40	16	1600	800 000 106	800 000 116	-	0.850
63	50	16	3100	800 000 107	800 000 117	-	1.550

d [mm]	D [mm]	H [mm]	H1 [mm]	L [mm]	L1 [mm]	L2 [mm]	L4 [mm]	L5 [mm]	L6 [mm]	z [mm]
16	50	57	27	93	77	56	25	32	45	67
20	50	57	27	95	77	56	25	32	45	66
25	58	67	30	108	97	65	25	39	58	77
32	68	73	36	119	97	71	25	39	58	83
40	84	90	44	137	128	85	45	54	74	99
50	97	97	51	147	128	89	45	54	74	105
63	124	116	64	168	152	101	45	66	87	113



DN10/15 - 50

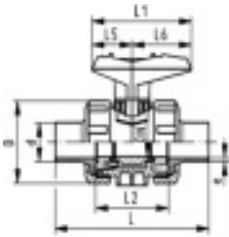

Ball valve type 546 PVC-U without mounting inserts With butt fusion spigots PE100 SDR11 metric

Model:

- For easy installation and removal
- Ball seals PTFE
- Without mounting inserts
- z-dimension, valve end and valve nut are not compatible with type 346

Option:

- Individual configuration of the valve (see form)
- Multifunctional module with integrated limit switches
- Pneumatic or electric actuators from +GF+

d [mm]	DN [mm]	PN	kv-value ($\Delta p=1$ bar) [l/min]	EPDM Code	FPM Code	GP	kg
20	15	16	185	800 000 142	800 000 152	-	0.160
25	20	16	350	800 000 143	800 000 153	-	0.240
32	25	16	700	800 000 144	800 000 154	-	0.340
40	32	16	1000	800 000 145	800 000 155	-	0.600
50	40	16	1600	800 000 146	800 000 156	-	0.830
63	50	16	3100	800 000 147	800 000 157	-	1.560

d [mm]	D [mm]	H [mm]	H1 [mm]	L [mm]	L1 [mm]	L2 [mm]	L4 [mm]	L5 [mm]	L6 [mm]	e [mm]
20	50	57	27	130	77	56	25	32	45	1,9
25	58	67	30	134	97	65	25	39	58	2,3
32	68	73	36	150	97	71	25	39	58	3
40	84	90	44	171	128	85	45	54	74	3,7
50	97	97	51	191	128	89	45	54	74	4,6
63	124	116	64	220	152	101	45	66	87	5,8



DN10/15 - 50

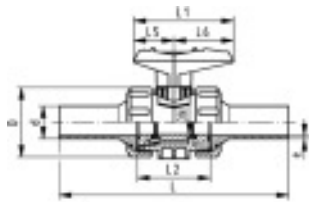

Ball valve type 546 PVC-U without mounting inserts With butt fusion spigots long PE100 SDR11 metric

Model:

- For easy installation and removal
- Ball seals PTFE
- Without mounting inserts
- Image and drawing DN65-100 please see **"New product ball valve DN65-100"**
- z-dimension, valve end and valve nut are **not compatible** with type 346 (DN10/15-50) resp. type 370 (DN65-100)

Option:

- Individual configuration of the valve (see form)
- Multifunctional module with integrated limit switches
- Pneumatic or electric actuators from +GF+

d [mm]	DN [mm]	PN	kv-value ($\Delta p=1$ bar) [l/min]	EPDM Code	FPM Code	GP	kg
20	15	16	185	800 000 282	800 000 292	-	0.170
25	20	16	350	800 000 283	800 000 293	-	0.250
32	25	16	700	800 000 284	800 000 294	-	0.370
40	32	16	1000	800 000 285	800 000 295	-	0.640
50	40	16	1600	800 000 286	800 000 296	-	0.910
63	50	16	3100	800 000 287	800 000 297	-	1.680
75	65	16	5000	800 000 288	800 000 298	-	5.000
90	80	16	7000	800 000 289	800 000 299	-	7.500
110	100	16	11000	800 000 290	800 000 300	-	11.800

d [mm]	D [mm]	H [mm]	H1 [mm]	L [mm]	L1 [mm]	L2 [mm]	L4 [mm]	L5 [mm]	L6 [mm]	e [mm]
20	50	57	27	193	77	56	25	32	45	2,25
25	58	67	30	216	97	65	25	39	58	2,3
32	68	73	36	223	97	71	25	39	58	3
40	84	90	44	249	128	85	45	54	74	3,7
50	97	97	51	271	128	89	45	54	74	4,6
63	124	116	64	321	152	101	45	66	87	5,8
75	166	149	85	386	270	136	70	64	206	6.8
90	200	161	105	421	270	141	70	64	206	8.2
110	238	178	123	484	320	164	120	64	256	10



DN10/15 - 50

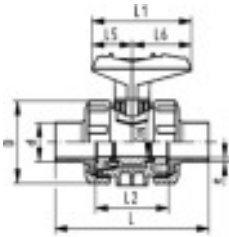

Ball valve type 546 PVC-U without mounting inserts With butt fusion spigots PE100 SDR17.6 metric

Model:

- For easy installation and removal
- Ball seals PTFE
- Without mounting inserts
- z-dimension, valve end and valve nut are not compatible with type 346

Option:

- Individual configuration of the valve (see form)
- Multifunctional module with integrated limit switches
- Pneumatic or electric actuators from +GF+

d [mm]	DN [mm]	PN	kv-value ($\Delta p=1$ bar) [l/min]	EPDM Code	FPM Code	GP	kg
40	32	10	1000	800 000 125	800 000 135	-	0.600
50	40	10	1600	800 000 126	800 000 136	-	0.830
63	50	10	3100	800 000 127	800 000 137	-	1.560

d [mm]	D [mm]	H [mm]	H1 [mm]	L [mm]	L1 [mm]	L2 [mm]	L4 [mm]	L5 [mm]	L6 [mm]	e [mm]
40	84	90	44	171	128	85	45	54	74	2,3
50	97	97	51	191	128	89	45	54	74	2,9
63	124	116	64	220	152	101	45	66	87	3,6



Ball valve type 546 PVC-U With lockable handle With solvent cement sockets metric

Model:

- Image and drawing DN65-100 please see "New product ball valve DN65-100"
- For easy installation and removal
- z-dimension, valve end and valve nut are **not compatible** with type 346 (DN10/15-50) resp. type 370 (DN65-100)
- Ball seals PTFE
- Integrated stainless steel mounting inserts
- Lockable hand lever with ratchet settings

Option:

- Individual configuration of the valve (see form)
- Multifunctional module with integrated limit switches
- Pneumatic or electric actuators from +GF+

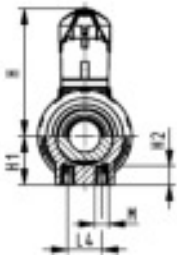
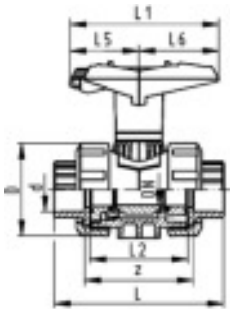

d [mm]	DN [mm]	PN	kv-value ($\Delta p=1$ bar) [l/min]	EPDM Code	FPM Code	GP	kg
16	10	16	71	161 546 081	161 546 091	10	0.165
20	15	16	185	161 546 082	161 546 092	10	0.165
25	20	16	350	161 546 083	161 546 093	10	0.255
32	25	16	700	161 546 084	161 546 094	6	0.355
40	32	16	1000	161 546 085	161 546 095	6	0.640
50	40	16	1600	161 546 086	161 546 096	4	0.840
63	50	16	3100	161 546 087	161 546 097	4	1.500
75	65	16	5000	161 546 088	161 546 098	-	5.200
90	80	16	7000	161 546 089	161 546 099	-	7.700
110	100	16	11000	161 546 090	161 546 100	-	12.000

d [mm]	D [mm]	H [mm]	H1 [mm]	H2 [mm]	L [mm]	L1 [mm]	L2 [mm]	L4 [mm]	L5 [mm]	L6 [mm]	M	z [mm]
16	50	79	27	12	92	87	56	25	42	45	M6	64
20	50	79	27	12	95	87	56	25	42	45	M6	64
25	58	88	30	12	110	108	65	25	50	58	M6	72
32	68	94	36	12	123	108	71	25	50	58	M6	79
40	84	113	44	15	146	140	85	45	66	75	M8	94
50	97	119	51	15	157	140	89	45	66	75	M8	95
63	124	141	64	15	183	165	101	45	78	87	M8	107
75	166	224	85	15	233	270	136	70	64	206	M8	144
90	200	235	105	15	254	270	141	70	64	206	M8	151
110	238	245	123	22	301	320	164	120	64	256	M12	174



DN10/15 - 50

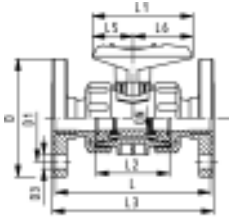

Ball valve type 546 PVC-U without mounting inserts With fixed flanges PVC-U serrated metric

Model:

- For easy installation and removal
- Ball seals PTFE
- Without mounting inserts
- z-dimension, valve end and valve nut are not compatible with type 346
- Overall length according to EN 558
- Connecting dimension: ISO 7005 PN10, EN 1092 PN10, DIN 2501 PN10

Option:

- Individual configuration of the valve (see form)
- Multifunctional module with integrated limit switches
- Pneumatic or electric actuators from +GF+

d [mm]	DN [mm]	PN	kv-value ($\Delta p=1$ bar) [l/min]	EPDM Code	FPM Code	GP	kg
20	15	16	185	800 000 182	800 000 192	-	0.370
25	20	16	350	800 000 183	800 000 193	-	0.510
32	25	16	700	800 000 184	800 000 194	-	0.740
40	32	16	1000	800 000 185	800 000 195	-	1.230
50	40	16	1600	800 000 186	800 000 196	-	1.610
63	50	16	3100	800 000 187	800 000 197	-	2.710

d [mm]	D [mm]	D1 [mm]	D3 [mm]	H [mm]	H1 [mm]	L [mm]	L1 [mm]	L2 [mm]	L3 [mm]	L4 [mm]	L5 [mm]	L6 [mm]
20	95	65	14	57	27	124	77	56	130	25	32	45
25	105	75	14	67	30	144	97	65	150	25	39	58
32	115	85	14	73	36	154	97	71	160	25	39	58
40	140	100	18	90	44	174	128	85	180	45	54	74
50	150	110	18	97	51	194	128	89	200	45	54	74
63	165	125	18	116	64	224	152	101	230	45	66	87

Component for Parts for Flange Assembly of Ball Vaves Type 546

21 79 01

Flange Adaptors, PVC-U Combined Jointing face flat and serrated, metric

d [mm]	DN [mm]	PN	Code	GP	kg
20	15	16	721 800 106	100	0.011
25	20	16	721 800 107	100	0.015
32	25	16	721 800 108	100	0.024
40	32	16	721 800 109	100	0.038
50	40	16	721 800 110	50	0.058
63	50	16	721 790 111	50	0.103
75	65	16	721 790 112	-	0.155
90	80	16	721 790 113	-	0.254
110	100	16	721 790 114	-	0.418

EPDM 48 40 00
FPM 49 40 00

Flat Gaskets

d [mm]	DN [mm]	Inch	PN	EPDM Code	FPM Code	GP	kg
20	15	½	10	748 400 015	749 400 015	-	0.003
25	20	¾	10	748 400 016	749 400 016	-	0.003
32	25	1	10	748 400 017	749 400 017	-	0.004
40	32	1 ¼	10	748 400 018	749 400 018	-	0.008
50	40	1 ½	10	748 400 019	749 400 019	-	0.012
63	50	2	10	748 400 020	749 400 020	-	0.017
75	65	2 ½	10	748 400 021	749 400 021	-	0.024
90	80	3	10	748 400 022	749 400 022	-	0.032
110	100	4	10	748 400 023	749 400 023	-	0.062

Profile Flange Gaskets, metric

d [mm]	EPDM Code	FPM Code	kg
20	748 440 101	749 440 101	0.008
25	748 440 102	749 440 102	0.011
32	748 440 103	749 440 103	0.014
40	748 440 104	749 440 104	0.020
50	748 440 105	749 440 105	0.021
63	748 440 106	749 440 106	0.040
75	748 440 107	749 440 107	0.054
90	748 440 108	749 440 108	0.060
110	748 440 109	749 440 109	0.083

21 70 00

Backing Flanges, PVC-U metric

d [mm]	DN [mm]	Inch	PN	Code	GP	kg
20	15	½	10	721 700 006	-	0.069
25	20	¾	10	721 700 007	-	0.092
32	25	1	10	721 700 008	-	0.132
40	32	1 ¼	10	721 700 009	-	0.194
50	40	1 ½	10	721 700 010	-	0.245
63	50	2	10	721 700 011	-	0.311
75	65	2 ½	10	721 700 012	-	0.375
90	80	3	10	721 700 013	-	0.471
110	100	4	10	721 700 014	-	0.554

27 70 04
27 70 05

Backing Flanges, PP-V for Socket Systems metric

d [mm]	Inch	DN [mm]	PN	Code	GP	kg
20		15	16	727 700 406	-	0.080
25		20	16	727 700 407	-	0.100
32		25	16	727 700 408	-	0.140
40		32	16	727 700 409	-	0.220
50		40	16	727 700 410	-	0.210
63		50	16	727 700 411	-	0.380
75		65	16	727 700 412	-	0.480
90		80	16	727 700 413	-	0.520
110		100	16	727 700 414	-	0.680

27 70 02

Backing Flanges, PP/Steel for Socket Systems metric

d [mm]	DN [mm]	PN	Code	kg
20	15	16	727 700 206	0.220
25	20	16	727 700 207	0.260
32	25	16	727 700 208	0.430
40	32	16	727 700 209	0.650
50	40	16	727 700 210	0.820
63	50	16	727 700 211	0.940
75	65	16	727 700 212	1.300
90	80	16	727 700 213	1.400
110	100	16	727 700 214	1.560

21 74 01

Fixed Flanges, PVC-U Combined jointing face: flat and serrated, metric

d [mm]	DN [mm]	Inch	PN	Code	GP	kg
20	15	1/2	16	721 740 106	-	0.100
25	20	3/4	16	721 740 107	-	0.130
32	25	1	16	721 740 108	-	0.185
40	32	1 1/4	16	721 740 109	-	0.305
50	40	1 1/2	16	721 740 110	-	0.368
63	50	2	16	721 740 111	-	0.510
75	65	2 1/2	10	721 740 112	-	0.520
90	80	3	10	721 740 113	-	0.720
110	100	4	10	721 740 114	-	0.920

Find the fitting solution with the Configurator

Ball valve

A01 Ball valve 546

Material

B01 PVC-U

Dimension

C05 DN 10 3/8"
C06 DN 15 1/2"
C07 DN 20 3/4"
C08 DN 25 1"
C09 DN 32 1 1/4"
C10 DN 40 1 1/2"
C11 DN 50 2"

Version

D01 standard, PTFE ball seal
D02 oilfree, PTFE ball seal
D03 silicon-free / paint compatible, PTFE ball seal for inch ASTM
D04 silicon-free / paint compatible, PVDF ball seal for metric

Seals

E01 EPDM seals
E02 FPM seals

Threaded inserts

F01 without threaded inserts
F02 with threaded inserts

Connecting parts

G01 PVC-U Cement socket metric
G02 PVC-U Cement socket JIS
G03 PVC-U Cement socket inch ASTM
G04 PVC-U Cement socket inch BS
G05 PVC-U Cement spigot metric
G06 PVC-U Threaded socket Rp
G07 PVC-U Threaded socket Rp reinforced
G08 PVC-U Threaded socket Rc
G09 PVC-U Threaded socket NPT
G30 PP-H Fusion socket metric
G32 PP-H Socket fusion spigot metric
G33 PP-H Threaded socket Rp reinforced
G34 PP-H Threaded socket NPT reinforced
G35 PP-H Butt fusion spigot SDR11 metric IR-PLUS
G36 PP-H Butt fusion spigot SDR17.6 metric
G37 PP-H Butt fusion spigot long SDR11 metric
G40 PE-100 Fusion socket metric
G41 PE-100 Butt fusion spigot SDR11 metric
G42 PE-100 Butt fusion spigot SDR17.6 metric
G43 PE-100 Butt fusion spigot long SDR11 metric
G60 Fixed flange PVC-U serrated metric
G61 Fixed flange PVC-U flat metric
G62 Fixed flange PVC-U JIS
G70 Backing flange PVC-U metric
G71 Backing flange PVC-U inch ANSI
G72 Backing flange PP-steel metric

Multi-functional module

I01 No multi-functional module
I02 Empty multi-functional module
I03 Module with 2 limit switches Ag, Ni
I04 Module with 2 limit switches Au
I05 Module with 2 inductive switches Namur
I06 Module with 2 inductive switches PNP
I07 Module with 2 inductive switches NPN

Handle

K01 Standard handle red
K02 Standard handle black
K11 Multi-functional handle red

Mounting plate

L01 without mounting plate
L02 with mounting plate

Example:

Type 546 PVC-U, dimension DN 32
PTFE ball seal, EPDM seals,
with threaded inserts and mounting plate,
connecting part left: PVC-U cement socket metric,
right: PE-100 butt fusion spigot lang SDR11 metric

That's all it takes to configure your ball valve.



Pneumatische Antriebe PA11/PA21

P01 PA 11/21 FC
P02 PA 11/21 FO
P03 PA 11/21 DA

Manual override

Q01 without manual override
Q02 with manual override

Stroke limiter

R01 without stroke limiter
R02 with stroke limiter

A01 B01 C09 D01 E01 F02 G01 G41 I05 K L01

left right

P02 Q01 R01 =



Copiable

Configurator +GF+ Ball Valve Type 546 PVC-U

Ball valve										
A01	Ball valve 546									
A02	Linear Ball Valve 110									
Material										
B01	PVC-U									
Dimension										
C05	DN 10	3/8"								
C06	DN 15	1/2"								
C07	DN 20	3/4"								
C08	DN 25	1"								
C09	DN 32	1 1/4"								
C10	DN 40	1 1/2"								
C11	DN 50	2"								
Version										
D01	standard, PTFE ball seal									
D02	oilfree, PTFE ball seal									
D03	silicon-free / paint compatible, PTFE ball seal for inch ASTM									
D04	silicon-free / paint compatible, PVDF ball seal for metric									
Seals										
E01	EPDM seals									
E02	FPM seals									
E03	FFPM (Kalrez) seals									
Threaded inserts										
F01	without threaded inserts									
F02	with threaded inserts									
Connection parts										
G01	PVC-U Cement socket metric									
G02	PVC-U Cement socket JIS									
G03	PVC-U Cement socket inch ASTM									
G04	PVC-U Cement socket inch BS									
G05	PVC-U Cement spigot metric									
G06	PVC-U Threaded socket Rp									
G07	PVC-U Threaded socket Rp reinforced									
G08	PVC-U Threaded socket Rc									
G09	PVC-U Threaded socket NPT									
G30	PP-H Fusion socket metric									
G32	PP-H Socket fusion spigot metric									
G33	PP-H Threaded socket Rp reinforced									
G34	PP-H Threaded socket NPT reinforced									
G35	PP-H Butt fusion spigot SDR11 metric IR-PLUS									
G36	PP-H Butt fusion spigot SDR17.6 metric									
G37	PP-H Butt fusion spigot long SDR11 metric									
G40	PE-100 Fusion socket metric									
G41	PE-100 Butt fusion spigot SDR11 metric									
G42	PE-100 Butt fusion spigot SDR17.6 metric									
G43	PE-100 Butt fusion spigot long SDR11 metric									
G60	Fixed flange PVC-U serrated metric									
G61	Fixed flange PVC-U flat metric									
G62	Fixed flange PVC-U JIS									
G70	Backing flange PVC-U metric									
G71	Backing flange PVC-U inch ANSI									
G72	Backing flange PP-steel metric									
G73	Backing flange PP-steel inch ANSI									
G80	PVC-U Valve end blank									
Multi-functional module										
I01	No multi-functional module									
I02	Empty multi-functional module									
I03	Module with 2 limit switches Ag, Ni									
I04	Module with 2 limit switches Au									
I05	Module with 2 inductive switches Namur									
I06	Module with 2 inductive switches PNP									
I07	Module with 2 inductive switches NPN									
Handle										
K01	Standard handle red									
K02	Standard handle black									
K11	Multi-functional handle red									
Mounting plate										
L01	without mounting plate									
L02	with mounting plate									
A01	B01	C	D	E	F	G	G	I	K	L
						left	right			

You will find a large selection of different versions in our range of products. New system elements also provide you with new opportunities for use. In order for us to supply exactly the ball valve you need for your application, we put together a selection menu for you (the maximum working pressure of the whole valve is determined by the maximum permissible nominal pressure of the connection part).

We supply what you put together.

PVC-C metric

Ball valves

Ball valve type 546 PVC-C

With solvent cement sockets metric

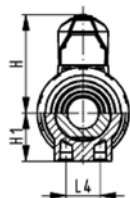
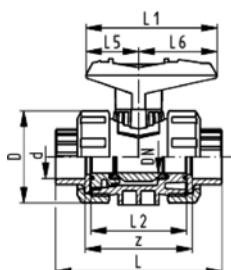
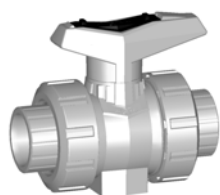

Model:

- For easy installation and removal
- z-dimension, valve end and valve nut are **not compatible** with type 346
- Ball seals PTFE
- Without mounting inserts

Option:

- Individual configuration of the valve (see form)
- Multifunctional module with integrated limit switches
- Pneumatic or electric actuators from +GF+

d [mm]	DN [mm]	PN	kv-value ($\Delta p=1$ bar) [l/min]	EPDM Code	FPM Code	kg
16	10	16	71	163 546 001	163 546 011	0.160
20	15	16	185	163 546 002	163 546 012	0.160
25	20	16	350	163 546 003	163 546 013	0.245
32	25	16	700	163 546 004	163 546 014	0.365
40	32	16	1000	163 546 005	163 546 015	0.660
50	40	16	1600	163 546 006	163 546 016	0.890
63	50	16	3100	163 546 007	163 546 017	1.650

d [mm]	D [mm]	H [mm]	H1 [mm]	L [mm]	L1 [mm]	L2 [mm]	L4 [mm]	L5 [mm]	L6 [mm]	z [mm]
16	50	57	27	92	77	56	25	32	45	64
20	50	57	27	95	77	56	25	32	45	64
25	58	67	30	110	97	65	25	39	58	72
32	68	73	36	123	97	71	25	39	58	79
40	84	90	44	146	128	85	45	54	74	94
50	97	97	51	157	128	89	45	54	74	95
63	124	116	64	183	152	101	45	66	87	107

PVC-C metric

Ball valve type 546 PVC-C With solvent cement spigots metric

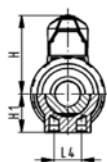
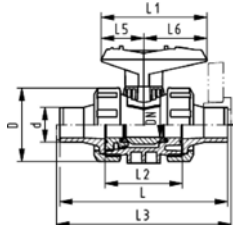
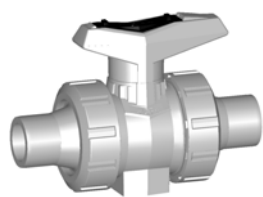

Model:

- For easy installation and removal
- z-dimension, valve end and valve nut are **not compatible** with type 346
- Ball seals PTFE
- Without mounting inserts

Option:

- Individual configuration of the valve (see form)
- Multifunctional module with integrated limit switches
- Pneumatic or electric actuators from +GF+

d [mm]	DN [mm]	PN	kv-value ($\Delta p=1$ bar) [l/min]	EPDM Code	FPM Code	kg
16	10	16	71	163 546 041	163 546 051	0.160
20	15	16	185	163 546 042	163 546 052	0.160
25	20	16	350	163 546 043	163 546 053	0.245
32	25	16	700	163 546 044	163 546 054	0.365
40	32	16	1000	163 546 045	163 546 055	0.660
50	40	16	1600	163 546 046	163 546 056	0.890
63	50	16	3100	163 546 047	163 546 057	1.650

d [mm]	D [mm]	H [mm]	H1 [mm]	L [mm]	L1 [mm]	L2 [mm]	L3 [mm]	L4 [mm]	L5 [mm]	L6 [mm]
16	50	57	27	114	77	56		25	32	45
20	50	57	27	124	77	56	130	25	32	45
25	58	67	30	144	97	65	150	25	39	58
32	68	73	36	154	97	71	160	25	39	58
40	84	90	44	174	128	85	180	45	54	74
50	97	97	51	194	128	89	200	45	54	74
63	124	116	64	224	152	101	230	45	66	87

PVC-C metric

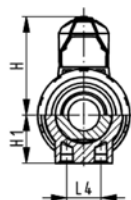
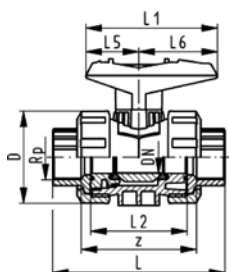
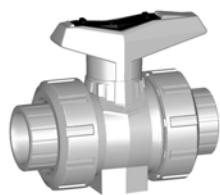

Ball valve type 546 PVC-C With threaded sockets Rp

Model:

- For easy installation and removal
- z-dimension, valve end and valve nut are **not compatible** with type 346
- Ball seals PTFE
- Without mounting inserts

Option:

- Individual configuration of the valve (see form)
- Multifunctional module with integrated limit switches
- Pneumatic or electric actuators from +GF+

Rp [inch]	DN [mm]	PN	kv-value ($\Delta p=1$ bar) [l/min]	EPDM Code	FPM Code	kg
3/8	10	10	71	163 546 021	163 546 031	0.160
1/2	15	10	185	163 546 022	163 546 032	0.160
3/4	20	10	350	163 546 023	163 546 033	0.245
1	25	10	700	163 546 024	163 546 034	0.365
1 1/4	32	10	1000	163 546 025	163 546 035	0.660
1 1/2	40	10	1600	163 546 026	163 546 036	0.890
2	50	10	3100	163 546 027	163 546 037	1.650

Rp [inch]	D [mm]	H [mm]	H1 [mm]	L [mm]	L1 [mm]	L2 [mm]	L4 [mm]	L5 [mm]	L6 [mm]	z [mm]
3/8	50	57	27	95	77	56	25	32	45	69
1/2	50	57	27	100	77	56	25	32	45	67
3/4	58	67	30	114	97	65	25	39	58	78
1	68	73	36	127	97	71	25	39	58	85
1 1/4	84	90	44	146	128	85	45	54	74	100
1 1/2	97	97	51	152	128	89	45	54	74	106
2	124	116	64	177	152	101	45	66	87	121

PVC-C metric

Ball valve type 546 PVC-C With mounting inserts With solvent cement sockets metric

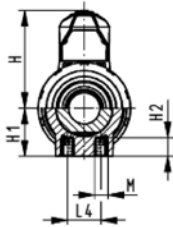
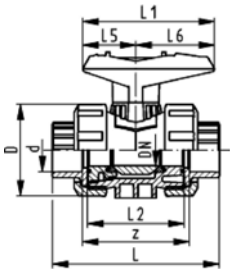
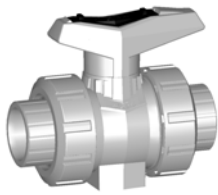

Model:

- For easy installation and removal
- z-dimension, valve end and valve nut are **not compatible** with type 346
- Ball seals PTFE
- Integrated stainless steel mounting inserts

Option:

- Individual configuration of the valve (see form)
- Multifunctional module with integrated limit switches
- Pneumatic or electric actuators from +GF+

d [mm]	DN [mm]	PN	kv-value ($\Delta p=1$ bar) [l/min]	EPDM Code	FPM Code	kg
16	10	16	71	163 546 061	163 546 071	0.160
20	15	16	185	163 546 062	163 546 072	0.160
25	20	16	350	163 546 063	163 546 073	0.245
32	25	16	700	163 546 064	163 546 074	0.365
40	32	16	1000	163 546 065	163 546 075	0.660
50	40	16	1600	163 546 066	163 546 076	0.890
63	50	16	3100	163 546 067	163 546 077	1.650

d [mm]	D [mm]	H [mm]	H1 [mm]	H2 [mm]	L [mm]	L1 [mm]	L2 [mm]	L4 [mm]	L5 [mm]	L6 [mm]	M	z [mm]
16	50	57	27	12	92	77	56	25	32	45	M6	64
20	50	57	27	12	95	77	56	25	32	45	M6	64
25	58	67	30	12	110	97	65	25	39	58	M6	72
32	68	73	36	12	123	97	71	25	39	58	M6	79
40	84	90	44	15	146	128	85	45	54	74	M8	94
50	97	97	51	15	157	128	89	45	54	74	M8	95
63	124	116	64	15	183	152	101	45	66	87	M8	107

PVC-C metric

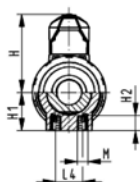
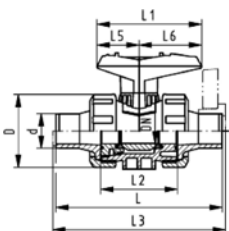
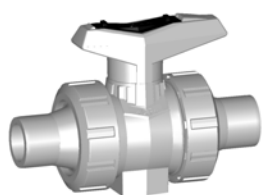

Ball valve type 546 PVC-C With mounting inserts With solvent cement spigots metric

Model:

- For easy installation and removal
- z-dimension, valve end and valve nut are **not compatible** with type 346
- Ball seals PTFE
- Integrated stainless steel mounting inserts

Option:

- Individual configuration of the valve (see form)
- Multifunctional module with integrated limit switches
- Pneumatic or electric actuators from +GF+

d [mm]	DN [mm]	PN	kv-value ($\Delta p=1$ bar) [l/min]	EPDM Code	FPM Code	kg	
16	10	16	71	163 546 381	163 546 391	0.162	
20	15	16	185	163 546 382	163 546 392	0.162	
25	20	16	350	163 546 383	163 546 393	0.247	
32	25	16	700	163 546 384	163 546 394	0.367	
40	32	16	1000	163 546 385	163 546 395	0.665	
50	40	16	1600	163 546 386	163 546 396	0.895	
63	50	16	3100	163 546 387	163 546 397	1.655	

d [mm]	D [mm]	H [mm]	H1 [mm]	H2 [mm]	L [mm]	L1 [mm]	L2 [mm]	L3 [mm]	L4 [mm]	L5 [mm]	L6 [mm]	M	
16	50	57	27	12	114	77	56		25	32	45	M6	
20	50	57	27	12	124	77	56	130	25	32	45	M6	
25	58	67	30	12	144	97	65	150	25	39	58	M6	
32	68	73	36	12	154	97	71	160	25	39	58	M6	
40	84	90	44	15	174	128	85	180	45	54	74	M8	
50	97	97	51	15	194	128	89	200	45	54	74	M8	
63	124	116	64	15	224	152	101	230	45	66	87	M8	

PVC-C metric

Ball valve type 546 PVC-C With mounting inserts With threaded sockets Rp

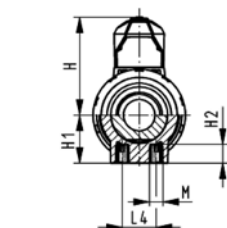
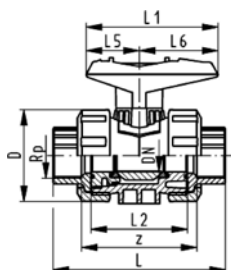
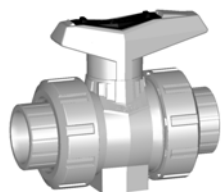

Model:

- For easy installation and removal
- z-dimension, valve end and valve nut are **not compatible** with type 346
- Ball seals PTFE
- Integrated stainless steel mounting inserts

Option:

- Individual configuration of the valve (see form)
- Multifunctional module with integrated limit switches
- Pneumatic or electric actuators from +GF+

Rp [inch]	DN [mm]	PN	kv-value ($\Delta p=1$ bar) [l/min]	EPDM Code	FPM Code	kg	
3/8	10	10	71	163 546 401	163 546 411	0.162	
1/2	15	10	185	163 546 402	163 546 412	0.162	
3/4	20	10	350	163 546 403	163 546 413	0.247	
1	25	10	700	163 546 404	163 546 414	0.367	
1 1/4	32	10	1000	163 546 405	163 546 415	0.665	
1 1/2	40	10	1600	163 546 406	163 546 416	0.895	
2	50	10	3100	163 546 407	163 546 417	1.655	

Rp [inch]	D [mm]	H [mm]	H1 [mm]	H2 [mm]	L [mm]	L1 [mm]	L2 [mm]	L4 [mm]	L5 [mm]	L6 [mm]	M	z [mm]	
3/8	50	57	27	12	95	77	56	25	32	45	M6	69	
1/2	50	57	27	12	100	77	56	25	32	45	M6	67	
3/4	58	67	30	12	114	97	65	25	39	58	M6	78	
1	68	73	36	12	127	97	71	25	39	58	M6	85	
1 1/4	84	90	44	12	146	128	85	45	54	74	M8	100	
1 1/2	97	97	51	15	152	128	89	45	54	74	M8	106	
2	124	116	64	15	177	152	101	45	66	87	M8	121	

PVC-C metric

Ball valve type 546 PVC-C With lockable handle With solvent cement sockets metric

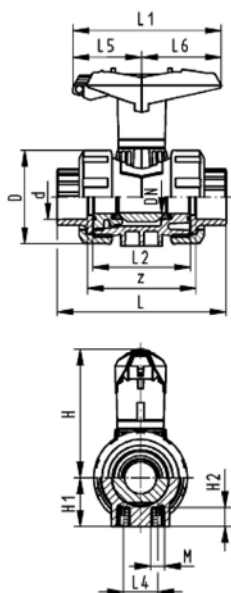

Model:

- For easy installation and removal
- z-dimension, valve end and valve nut are **not compatible** with type 346
- Ball seals PTFE
- Integrated stainless steel mounting inserts
- Lockable hand lever with ratchet settings

Option:

- Individual configuration of the valve (see form)
- Multifunctional module with integrated limit switches
- Pneumatic or electric actuators from +GF+

d [mm]	DN [mm]	PN	kv-value ($\Delta p=1$ bar) [l/min]	EPDM Code	FPM Code	kg	
16	10	16	71	163 546 081	163 546 091	0.175	
20	15	16	185	163 546 082	163 546 092	0.175	
25	20	16	350	163 546 083	163 546 093	0.270	
32	25	16	700	163 546 084	163 546 094	0.390	
40	32	16	1000	163 546 085	163 546 095	0.700	
50	40	16	1600	163 546 086	163 546 096	0.930	
63	50	16	3100	163 546 087	163 546 097	1.695	

d [mm]	D [mm]	H [mm]	H1 [mm]	H2 [mm]	L [mm]	L1 [mm]	L2 [mm]	L4 [mm]	L5 [mm]	L6 [mm]	M	z [mm]	
16	50	79	27	12	92	87	56	25	42	45	M6	64	
20	50	79	27	12	95	87	56	25	42	45	M6	64	
25	58	88	30	12	110	108	65	25	50	58	M6	72	
32	68	94	36	12	123	108	71	25	50	58	M6	79	
40	84	113	44	15	146	140	85	45	66	75	M8	94	
50	97	119	51	15	157	140	89	45	66	75	M8	95	
63	124	141	64	15	183	165	101	45	78	87	M8	107	

PVC-C metric

Valve end 546 PVC-C (G11) With solvent cement socket metric

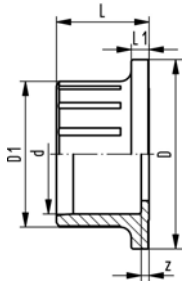

d [mm]	PN	Code	kg	D [mm]	D1 [mm]	L [mm]	L1 [mm]	z [mm]
16	16	163 481 275	0.009	38	23.20	18	4	4
20	16	163 481 276	0.011	38	27.20	20	4	4
25	16	163 481 277	0.016	44	33.20	23	5	4
32	16	163 481 278	0.025	53	41.00	26	5	4
40	16	163 481 279	0.043	65	51.00	31	5	5
50	16	163 481 280	0.064	77	62.00	34	6	3
63	16	163 481 281	0.119	99	77.00	41	7	3

Valve end 546 PVC-C (G13) With solvent cement socket Inch ASTM

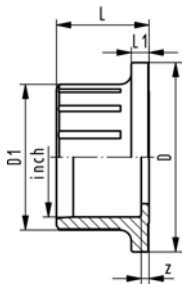

Inch	PN	Code	kg	D [mm]	D1 [mm]	L [mm]	L1 [mm]	z [mm]
3/8	16	163 481 311	0.012	38	24.30	25	4	6
1/2	16	163 481 312	0.014	38	29.50	25	4	2
3/4	16	163 481 313	0.020	44	35.30	28	5	3
1	16	163 481 314	0.031	53	43.30	31	5	3
1 1/4	16	163 481 315	0.046	65	52.80	34	5	3
1 1/2	16	163 481 316	0.067	77	59.60	38	6	3
2	16	163 481 317	0.118	99	72.70	41	7	3

Valve end 546 PVC-C (G14) With solvent cement spigot metric

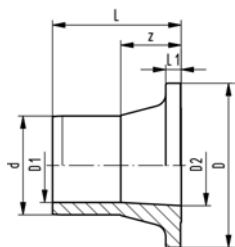

d [mm]	PN	Code	kg	D [mm]	D1 [mm]	D2 [mm]	L [mm]	L1 [mm]	z [mm]
16	16	163 481 300	0.012	38	10.00	15.50	29	4	15
20	16	163 481 301	0.015	38	14.00	15.50	34	4	18
25	16	163 481 302	0.023	44	19.00	20.50	39	5	20
32	16	163 481 303	0.040	53	24.00	26.10	42	5	20
40	16	163 481 304	0.054	65	31.00	32.80	45	5	19
50	16	163 481 305	0.093	77	39.00	41.30	53	6	22
63	16	163 481 306	0.177	99	49.00	51.20	62	7	24

PVC-C metric

Valve end 546 PVC-C (G15) With threaded socket Rp

Model:

- Connection to plastic thread only
- Do not use thread sealing pastes that are harmful to PVC-C

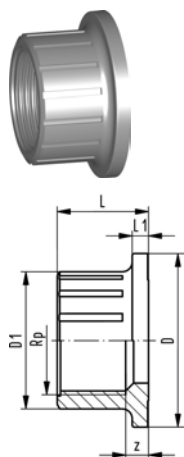

Rp [inch]	PN	Code	kg	D [mm]	D1 [mm]	L [mm]	L1 [mm]	z [mm]
3/8	10	163 481 286	0.011	38	24.00	20	4	7
1/2	10	163 481 287	0.013	38	28.00	22	4	6
3/4	10	163 481 288	0.019	44	33.80	25	5	7
1	10	163 481 289	0.031	53	42.00	28	5	7
1 1/4	10	163 481 290	0.047	65	52.00	30	5	7
1 1/2	10	163 481 291	0.081	77	63.00	32	6	9
2	10	163 481 292	0.150	99	77.50	38	7	10

Valve end 546 PVC-C (G16) With threaded socket Rp reinforced

Model:

- Connection to plastic or metal
- Reinforcing ring stainless (A2)
- Do not use thread sealing pastes that are harmful to PVC-C

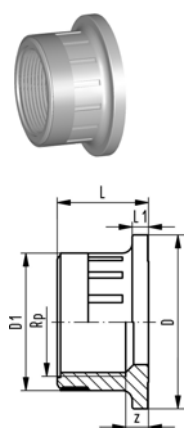

Rp [inch]	PN	Code	kg	D [mm]	D1 [mm]	L [mm]	L1 [mm]	z [mm]
3/8	16	163 481 400	0.014	38	24.00	20	4	7
1/2	16	163 481 401	0.018	38	28.00	22	4	6
3/4	16	163 481 402	0.025	44	33.80	25	5	7
1	16	163 481 403	0.044	53	42.00	28	5	7
1 1/4	16	163 481 404	0.064	65	52.00	30	5	7
1 1/2	16	163 481 405	0.106	77	63.00	32	6	9
2	16	163 481 406	0.182	99	77.50	38	7	10

Valve end 546 PVC-C (G17) With threaded socket NPT

Model:

- Connection to plastic thread only
- Do not use thread sealing pastes that are harmful to PVC-C

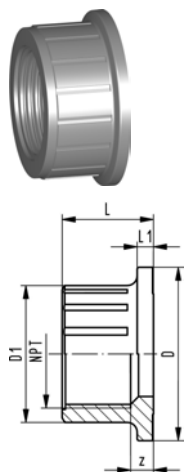

NPT [inch]	PN	Code	kg	D [mm]	D1 [mm]	L [mm]	L1 [mm]	z [mm]
3/8	10	163 481 322	0.014	38	26.20	21	4	7
1/2	10	163 481 323	0.019	38	33.30	21	4	4
3/4	10	163 481 324	0.026	44	38.90	23	5	5
1	10	163 481 325	0.043	53	47.00	28	5	6
1 1/4	10	163 481 326	0.064	65	56.90	31	5	7
1 1/2	10	163 481 327	0.093	77	64.70	34	6	11
2	10	163 481 328	0.157	99	77.40	41	7	17

PVC-C metric

Valve end 546 PVC-C (G72) Assembly with backing flange PP-St metric

Model:

- Joint made with special adhesive Tangit for PVC-C
- Connecting dimensions: ISO 7005 / EN 1092 / DIN 2501 PN10

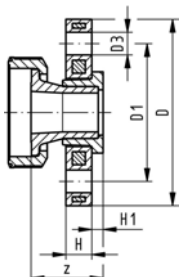

d [mm]	DN [mm]	PN	Code	kg	D [mm]	D1 [mm]	D3 [mm]	H [mm]	H1 [mm]	z [mm]
20	15	16	163 481 412	0.265	95	65.00	14.0	12	6	37
25	20	16	163 481 413	0.330	105	75.00	14.0	12	7	42
32	25	16	163 481 414	0.540	115	85.00	14.0	16	7	45
40	32	16	163 481 415	0.820	140	100.00	18.0	16	8	48
50	40	16	163 481 416	1.075	150	110.00	18.0	18	8	56
63	50	16	163 481 417	1.435	165	125.00	18.0	18	9	65

Valve end 546 PVC-C (G73) Assembly with backing flange PP-St Inch ANSI

Model:

- Joint made with special adhesive Tangit for PVC-C
- Connecting dimensions: ANSI B 16.5, ASTM D 4024, BS 1560 (bolt circle 150 lbs)

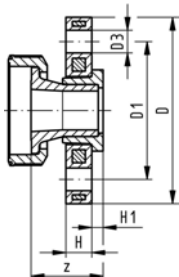

Inch	DN [mm]	PN	Code	kg	D [mm]	D1 [mm]	D3 [mm]	H [mm]	H1 [mm]	z [mm]
½	15	16	163 481 425	0.255	95	60.00	16.0	12	6	37
¾	20	16	163 481 426	0.316	105	70.00	16.0	12	7	42
1	25	16	163 481 427	0.530	115	79.00	16.0	16	7	45
1 ¼	32	16	163 481 428	0.835	140	89.00	16.0	16	8	47
1 ½	40	16	163 481 429	1.135	150	98.00	16.0	18	8	56
2	50	16	163 481 430	1.435	165	121.00	19.0	18	9	65

Union nut 546 PVC-C

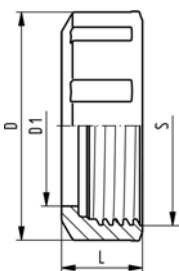

d [mm]	DN [mm]	Code	kg	D [mm]	D1 [mm]	L [mm]	S [mm]
16-20	10-15	163 481 226	0.013	50	33.70	19	42
25	20	163 481 227	0.019	58	39.30	20	48
32	25	163 481 228	0.028	68	47.40	24	58
40	32	163 481 229	0.054	84	57.40	27	71
50	40	163 481 230	0.072	97	65.20	30	84
63	50	163 481 231	0.225	124	79.00	36	106

Ball valves

Ball valve type 546 ABS With solvent cement sockets metric

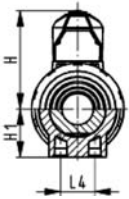
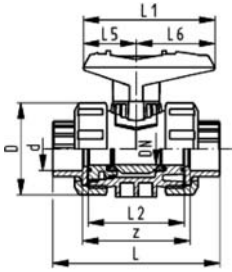

Model:

- For easy installation and removal
- z-dimension, valve end and valve nut are **not compatible** with type 346
- Ball seals PTFE
- Without mounting inserts

Option:

- Individual configuration of the valve (see form)
- Multifunctional module with integrated limit switches
- Pneumatic or electric actuators from +GF+

d [mm]	DN [mm]	PN	kv-value ($\Delta p=1$ bar) [l/min]	EPDM Code	kg
16	10	10	71	169 546 001	0.112
20	15	10	185	169 546 002	0.114
25	20	10	350	169 546 003	0.178
32	25	10	700	169 546 004	0.258
40	32	10	1000	169 546 005	0.457
50	40	10	1600	169 546 006	0.642
63	50	10	3100	169 546 007	1.175

d [mm]	D [mm]	H [mm]	H1 [mm]	L [mm]	L1 [mm]	L2 [mm]	L4 [mm]	L5 [mm]	L6 [mm]	z [mm]
16	50	57	27	92	77	56	25	32	45	64
20	50	57	27	95	77	56	25	32	45	64
25	58	67	30	110	97	65	25	39	58	72
32	68	73	36	123	97	71	25	39	58	79
40	84	90	44	146	128	85	45	54	74	94
50	97	97	51	157	128	89	45	54	74	95
63	124	116	64	183	152	101	45	66	87	107



Ball valve type 546 ABS With mounting inserts With solvent cement sockets metric

Model:

- For easy installation and removal
- z-dimension, valve end and valve nut are **not compatible** with type 346
- Ball seals PTFE
- Integrated stainless steel mounting inserts

Option:

- Individual configuration of the valve (see form)
- Multifunctional module with integrated limit switches
- Pneumatic or electric actuators from +GF+

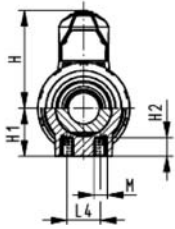
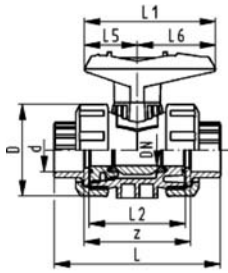

d [mm]	DN [mm]	PN	kv-value ($\Delta p=1$ bar) [l/min]	EPDM Code	kg
16	10	10	71	169 546 061	0.112
20	15	10	185	169 546 062	0.114
25	20	10	350	169 546 063	0.178
32	25	10	700	169 546 064	0.258
40	32	10	1000	169 546 065	0.457
50	40	10	1600	169 546 066	0.642
63	50	10	3100	169 546 067	1.175

d [mm]	D [mm]	H [mm]	H1 [mm]	H2 [mm]	L [mm]	L1 [mm]	L2 [mm]	L4 [mm]	L5 [mm]	L6 [mm]	M	z [mm]
16	50	57	27	12	92	77	56	25	32	45	M6	64
20	50	57	27	12	95	77	56	25	32	45	M6	64
25	58	67	30	12	110	97	65	25	39	58	M6	72
32	68	73	36	12	123	97	71	25	39	58	M6	79
40	84	90	44	15	146	128	85	45	54	74	M8	94
50	97	97	51	15	157	128	89	45	54	74	M8	95
63	124	116	64	15	183	152	101	45	66	87	M8	107

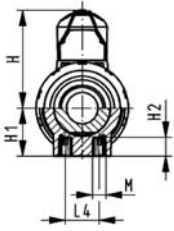
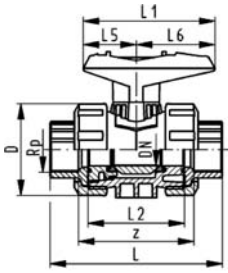

Ball valve type 546 ABS With mounting inserts With threaded sockets Rp

Model:

- For easy installation and removal
- z-dimension, valve end and valve nut are **not compatible** with type 346
- Ball seals PTFE
- Integrated stainless steel mounting inserts

Option:

- Individual configuration of the valve (see form)
- Multifunctional module with integrated limit switches
- Pneumatic or electric actuators from +GF+

Rp [inch]	DN [mm]	PN	kv-value ($\Delta p=1$ bar) [l/min]	EPDM Code	kg
3/8	10	10	71	169 546 021	0.112
1/2	15	10	185	169 546 022	0.114
3/4	20	10	350	169 546 023	0.178
1	25	10	700	169 546 024	0.258
1 1/4	32	10	1000	169 546 025	0.457
1 1/2	40	10	1600	169 546 026	0.642
2	50	10	3100	169 546 027	1.175

Rp [inch]	D [mm]	H [mm]	H1 [mm]	H2 [mm]	L [mm]	L1 [mm]	L2 [mm]	L4 [mm]	L5 [mm]	L6 [mm]	M	z [mm]
3/8	50	57	27	12	95	77	56	25	32	45	M6	69
1/2	50	57	27	12	100	77	56	25	32	45	M6	67
3/4	58	67	30	12	114	97	65	25	39	58	M6	78
1	68	73	36	12	127	97	71	25	39	58	M6	85
1 1/4	84	90	44	15	146	128	85	45	54	74	M8	100
1 1/2	97	97	51	15	152	128	89	45	54	74	M8	106
2	124	116	64	15	177	152	101	45	66	87	M8	121

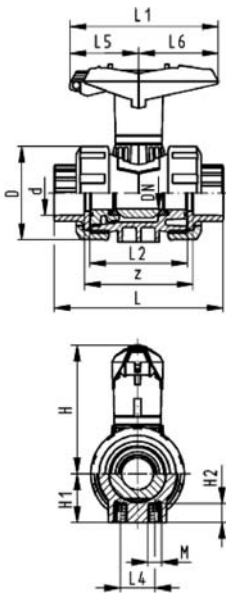

Ball valve type 546 ABS With lockable handle With solvent cement sockets metric

Model:

- For easy installation and removal
- z-dimension, valve end and valve nut are **not compatible** with type 346
- Ball seals PTFE
- Integrated stainless steel mounting inserts
- Lockable hand lever with ratchet settings

Option:

- Individual configuration of the valve (see form)
- Multifunctional module with integrated limit switches
- Pneumatic or electric actuators from +GF+

d [mm]	DN [mm]	PN	kv-value ($\Delta p=1$ bar) [l/min]	EPDM Code	kg								
16	10	10	71	169 546 081	0.121								
20	15	10	185	169 546 082	0.123								
25	20	10	350	169 546 083	0.193								
32	25	10	700	169 546 084	0.273								
40	32	10	1000	169 546 085	0.480								
50	40	10	1600	169 546 086	0.665								
63	50	10	3100	169 546 087	1.205								

d [mm]	D [mm]	H [mm]	H1 [mm]	H2 [mm]	L [mm]	L1 [mm]	L2 [mm]	L4 [mm]	L5 [mm]	L6 [mm]	M	z [mm]		
16	50	79	27	12	92	87	56	25	42	45	M6	64		
20	50	79	27	12	95	87	56	25	42	45	M6	64		
25	58	88	30	12	110	108	65	25	50	58	M6	72		
32	68	94	36	12	123	108	71	25	50	58	M6	79		
40	84	113	44	15	146	140	85	45	66	75	M8	94		
50	97	119	51	15	157	140	89	45	66	75	M8	95		
63	124	141	64	15	183	165	101	45	78	87	M8	107		

Ball Valves 546

Ball valve type 546 PP-H With mounting inserts With fusion sockets metric

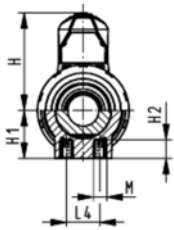
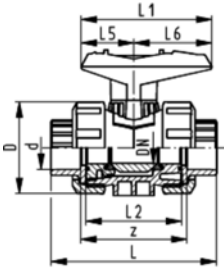

Model:

- Material: PP-H
- For easy installation and removal
- Ball seals PTFE
- Integrated stainless steel mounting inserts
- Image and drawing DN65-100 please see **"New product ball valve DN65-100"**
- z-dimension, valve end and union nut are **not compatible** with type 346 (DN10/15-50) resp. type 370 (DN65-100)

Option:

- Individual configuration of the valve (see form)
- Multifunctional module with integrated limit switches
- Pneumatic or electric actuators from +GF+

d [mm]	DN [mm]	PN	kv-value ($\Delta p=1$ bar) [l/min]	EPDM Code	FPM Code	kg	
16	10	10	71	167 546 401	167 546 411	0.115	
20	15	10	185	167 546 402	167 546 412	0.115	
25	20	10	350	167 546 403	167 546 413	0.180	
32	25	10	700	167 546 404	167 546 414	0.255	
40	32	10	1000	167 546 405	167 546 415	0.440	
50	40	10	1600	167 546 406	167 546 416	0.610	
63	50	10	3100	167 546 407	167 546 417	1.145	
75	65	10	5000	167 546 408	167 546 418	3.700	
90	80	10	7000	167 546 409	167 546 419	5.500	
110	100	10	11000	167 546 410	167 546 420	8.700	

d [mm]	D [mm]	H [mm]	H1 [mm]	H2 [mm]	L [mm]	L1 [mm]	L2 [mm]	L4 [mm]	L5 [mm]	L6 [mm]	M	z [mm]	
16	50	57	27	12	93	77	56	25	32	45	M6	67	
20	50	57	27	12	95	77	56	25	32	45	M6	66	
25	58	67	30	12	109	97	65	25	39	58	M6	77	
32	68	73	36	12	119	97	71	25	39	58	M6	83	
40	84	90	44	15	135	128	85	45	54	74	M8	99	
50	97	97	51	15	147	128	89	45	54	74	M8	105	
63	124	116	64	15	168	152	101	45	66	87	M8	117	
75	166	149	85	15	233	270	136	70	64	206	M8	167	
90	200	161	105	15	254	270	141	70	64	206	M8	180	
110	238	178	123	22	301	320	164	120	64	256	M12	215	



DN10/15 - 50

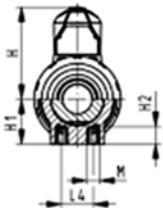
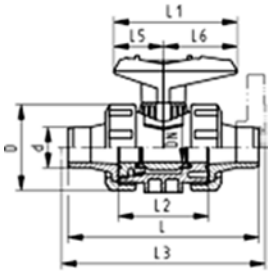



Ball valve type 546 PP-H With mounting inserts With socket fusion spigots metric



Model:

- Material: PP-H
- For easy installation and removal
- Ball seals PTFE
- Integrated stainless steel mounting inserts
- Image and drawing DN65-100 please see **"New product ball valve DN65-100"**
- z-dimension, valve end and union nut are **not compatible** with type 346 (DN10/15-50) resp. type 370 (DN65-100)

Option:

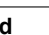
- Individual configuration of the valve (see form)
- Multifunctional module with integrated limit switches
- Pneumatic or electric actuators from +GF+

d [mm]	DN [mm]	PN	kv-value ($\Delta p=1$ bar) [l/min]	EPDM Code	FPM Code	kg	
16	10	10	71	167 546 041	167 546 051	0.120	
20	15	10	185	167 546 042	167 546 052	0.120	
25	20	10	350	167 546 043	167 546 053	0.180	
32	25	10	700	167 546 044	167 546 054	0.260	
40	32	10	1000	167 546 045	167 546 055	0.450	
50	40	10	1600	167 546 046	167 546 056	0.640	
63	50	10	3100	167 546 047	167 546 057	1.210	
 75	65	10	5000	167 546 048	167 546 058	3.800	
 90	80	10	7000	167 546 049	167 546 059	5.600	
 110	100	10	11000	167 546 050	167 546 060	8.800	

d [mm]	D [mm]	H [mm]	H1 [mm]	H2 [mm]	L [mm]	L1 [mm]	L2 [mm]	L3 [mm]	L4 [mm]	L5 [mm]	L6 [mm]	M	
16	50	57	27	12	110	77	56		25	32	45	M6	
20	50	57	27	12	120	77	56	130	25	32	45	M6	
25	58	67	30	12	139	97	65	150	25	39	58	M6	
32	68	73	36	12	150	97	71	160	25	39	58	M6	
40	84	90	44	15	170	128	85	180	45	54	74	M8	
50	97	97	51	15	190	128	89	200	45	54	74	M8	
63	124	116	64	15	220	152	101	230	45	66	87	M8	
 75	166	149	85	15	280	270	136	290	70	64	206	M8	
 90	200	161	105	15	296	270	141	310	70	64	206	M8	
 110	238	178	123	22	336	320	164	350	120	64	256	M12	



DN10/15 - 50

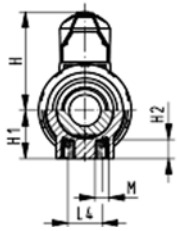
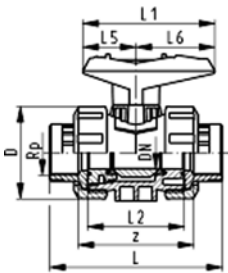

Ball valve type 546 PP-H With mounting inserts With threaded sockets Rp

Model:

- Material: PP-H
- For easy installation and removal
- Ball seals PTFE
- Integrated stainless steel mounting inserts
- z-dimension, valve end and union nut are not compatible with type 346

Option:

- Individual configuration of the valve (see form)
- Multifunctional module with integrated limit switches
- Pneumatic or electric actuators from +GF+

Rp [inch]	DN [mm]	PN	kv-value ($\Delta p=1$ bar) [l/min]	EPDM Code	FPM Code	kg							
3/8	10	10	71	167 546 021	167 546 031	0.120							
1/2	15	10	185	167 546 022	167 546 032	0.120							
3/4	20	10	350	167 546 023	167 546 033	0.180							
1	25	10	700	167 546 024	167 546 034	0.270							
1 1/4	32	10	1000	167 546 025	167 546 035	0.460							
1 1/2	40	10	1600	167 546 026	167 546 036	0.635							
2	50	10	3100	167 546 027	167 546 037	1.190							

Rp [inch]	D [mm]	H [mm]	H1 [mm]	H2 [mm]	L [mm]	L1 [mm]	L2 [mm]	L4 [mm]	L5 [mm]	L6 [mm]	M	z [mm]		
3/8	50	57	27	12	96	77	56	25	32	45	M6	69		
1/2	50	57	27	12	99	77	56	25	32	45	M6	67		
3/4	58	67	30	12	111	97	65	25	39	58	M6	78		
1	68	73	36	12	127	97	71	25	39	58	M6	85		
1 1/4	84	90	44	15	146	128	85	45	54	74	M8	100		
1 1/2	97	97	51	15	157	128	89	45	54	74	M8	106		
2	124	116	64	15	183	152	101	45	66	87	M8	121		



DN10/15 - 50

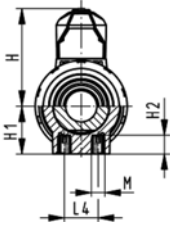
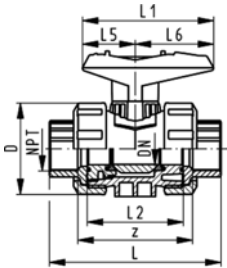

Ball valve type 546 PP-H With mounting inserts With threaded sockets NPT

Model:

- Material: PP-H
- For easy installation and removal
- Ball seals PTFE
- Integrated stainless steel mounting inserts
- z-dimension, valve end and union nut are not compatible with type 346

Option:

- Individual configuration of the valve (see form)
- Multifunctional module with integrated limit switches
- Pneumatic or electric actuators from +GF+

NPT [inch]	DN [mm]	PN	kv-value ($\Delta p=1$ bar) [l/min]	EPDM Code	FPM Code	kg							
3/8	10	10	71	167 546 321	167 546 331	0.120							
1/2	15	10	185	167 546 322	167 546 332	0.120							
3/4	20	10	350	167 546 323	167 546 333	0.180							
1	25	10	700	167 546 324	167 546 334	0.270							
1 1/4	32	10	1000	167 546 325	167 546 335	0.460							
1 1/2	40	10	1600	167 546 326	167 546 336	0.635							
2	50	10	3100	167 546 327	167 546 337	1.190							

NPT [inch]	D [mm]	H [mm]	H1 [mm]	H2 [mm]	L [mm]	L1 [mm]	L2 [mm]	L4 [mm]	L5 [mm]	L6 [mm]	M	z [mm]
3/8	50	57	27	12	96	77	56	25	32	45	M6	71
1/2	50	57	27	12	99	77	56	25	32	45	M6	64
3/4	58	67	30	12	111	97	65	25	39	58	M6	76
1	68	73	36	12	127	97	71	25	39	58	M6	83
1 1/4	84	90	44	15	146	128	85	45	54	74	M8	100
1 1/2	97	97	51	15	157	128	89	45	54	74	M8	111
2	124	116	64	15	183	152	101	45	66	87	M8	134



DN10/15 - 50

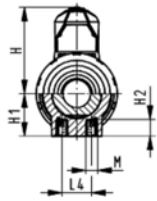
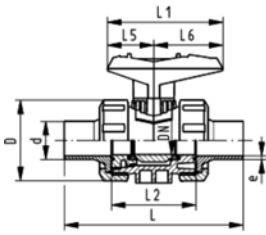

Ball valve type 546 PP-H With mounting inserts With butt fusion spigots IR-Plus SDR11 metric

Model:

- Material: PP-H
- For easy installation and removal
- Ball seals PTFE
- Integrated stainless steel mounting inserts
- Image and drawing DN65-100 please see **"New product ball valve DN65-100"**
- z-dimension, valve end and union nut are **not compatible** with type 346 (DN10/15-50) resp. type 370 (DN65-100)

Option:

- Individual configuration of the valve (see form)
- Multifunctional module with integrated limit switches
- Pneumatic or electric actuators from +GF+

d [mm]	DN [mm]	PN	kv-value ($\Delta p=1$ bar) [l/min]	EPDM Code	FPM Code	kg
20	15	10	185	167 546 442	167 546 452	0.120
25	20	10	350	167 546 443	167 546 453	0.180
32	25	10	700	167 546 444	167 546 454	0.255
40	32	10	1000	167 546 445	167 546 455	0.440
50	40	10	1600	167 546 446	167 546 456	0.620
63	50	10	3100	167 546 447	167 546 457	1.200
75	65	10	5000	167 546 448	167 546 458	3.800
90	80	10	7000	167 546 449	167 546 459	5.500
110	100	10	11000	167 546 450	167 546 460	8.700

d [mm]	D [mm]	H [mm]	H1 [mm]	H2 [mm]	L [mm]	L1 [mm]	L2 [mm]	L4 [mm]	L5 [mm]	L6 [mm]	M	e [mm]
20	50	57	27	12	130	77	56	25	32	45	M6	1,9
25	58	67	30	12	143	97	65	25	39	58	M6	2,3
32	68	73	36	12	150	97	71	25	39	58	M6	3
40	84	90	44	15	171	128	85	45	54	74	M8	3,7
50	97	97	51	15	191	128	89	45	54	74	M8	4,6
63	124	116	64	15	220	152	101	45	66	87	M8	5,8
75	166	149	85	15	266	270	136	70	64	206	M8	8.2
90	200	161	105	15	264	270	141	70	64	206	M8	9.9
110	238	178	123	22	301	320	164	120	64	256	M12	12



DN10/15 - 50

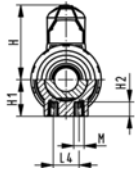
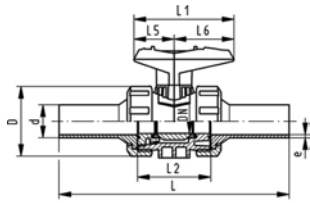

Ball valve type 546 PP-H With mounting inserts With butt fusion spigots long SDR11 metric

Model:

- Material: PP-H
- For easy installation and removal
- Ball seals PTFE
- Integrated stainless steel mounting inserts
- z-dimension, valve end and union nut are not compatible with type 346

Option:

- Individual configuration of the valve (see form)
- Multifunctional module with integrated limit switches
- Pneumatic or electric actuators from +GF+

d [mm]	DN [mm]	PN	kv-value ($\Delta p=1$ bar) [l/min]	EPDM Code	FPM Code	kg						
20	15	10	185	167 546 262	167 546 272	0.130						
25	20	10	350	167 546 263	167 546 273	0.195						
32	25	10	700	167 546 264	167 546 274	0.280						
40	32	10	1000	167 546 265	167 546 275	0.480						
50	40	10	1600	167 546 266	167 546 276	0.700						
63	50	10	3100	167 546 267	167 546 277	1.320						

d [mm]	D [mm]	H [mm]	H1 [mm]	H2 [mm]	L [mm]	L1 [mm]	L2 [mm]	L4 [mm]	L5 [mm]	L6 [mm]	M	e [mm]		
20	50	57	27	12	193	77	56	25	32	45	M6	2,3		
25	58	67	30	12	216	97	65	25	39	58	M6	2,3		
32	68	73	36	12	223	97	71	25	39	58	M6	3		
40	84	90	44	15	249	128	85	45	54	74	M8	3,7		
50	97	97	51	15	271	128	89	45	54	74	M8	4,6		
63	124	116	64	15	321	152	101	45	66	87	M8	5,8		



DN10/15 - 50

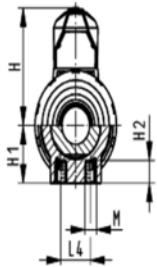
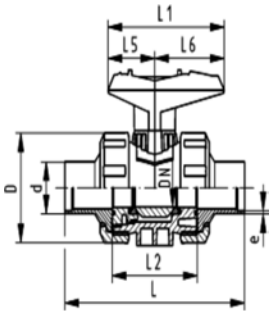

Ball valve type 546 PP-H With mounting inserts With butt fusion spigots SDR17.6 metric

Model:

- Material: PP-H
- For easy installation and removal
- Ball seals PTFE
- Integrated stainless steel mounting inserts
- Image and drawing DN65-100 please see **"New product ball valve DN65-100"**
- z-dimension, valve end and union nut are **not compatible** with type 346 (DN10/15-50) resp. type 370 (DN65-100)

Option:

- Individual configuration of the valve (see form)
- Multifunctional module with integrated limit switches
- Pneumatic or electric actuators from +GF+

d [mm]	DN [mm]	PN	kv-value ($\Delta p=1$ bar) [l/min]	EPDM Code	FPM Code	kg
50	40	6	1600	167 546 066	167 546 076	0.635
63	50	6	3100	167 546 067	167 546 077	1.200
75	65	6	5000	167 546 068	167 546 078	3.800
90	80	6	7000	167 546 069	167 546 079	5.500
110	100	6	11000	167 546 070	167 546 080	8.600

d [mm]	D [mm]	H [mm]	H1 [mm]	H2 [mm]	L [mm]	L1 [mm]	L2 [mm]	L4 [mm]	L5 [mm]	L6 [mm]	M	e [mm]
50	97	97	51	15	191	128	89	45	54	74	M8	2,9
63	124	116	64	15	220	152	101	45	66	87	M8	3,6
75	166	149	85	15	266	270	136	70	64	206	M8	4,7
90	200	161	105	15	264	270	141	70	64	206	M8	5,5
110	238	178	123	22	301	320	164	120	64	256	M12	6,8



DN10/15 - 50

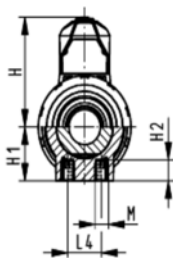
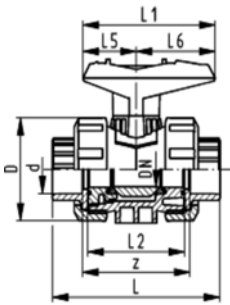

Ball valve type 546 PP-H With mounting inserts With fusion sockets PE100 metric

Model:

- Material: PP-H
- For easy installation and removal
- Ball seals PTFE
- Integrated stainless steel mounting inserts
- z-dimension, valve end and union nut are not compatible with type 346

Option:

- Individual configuration of the valve (see form)
- Multifunctional module with integrated limit switches
- Pneumatic or electric actuators from +GF+

d [mm]	DN [mm]	PN	kv-value ($\Delta p=1$ bar) [l/min]	EPDM Code	FPM Code	kg
16	10	10	71	167 546 161	167 546 171	0.120
20	15	10	185	167 546 162	167 546 172	0.120
25	20	10	350	167 546 163	167 546 173	0.180
32	25	10	700	167 546 164	167 546 174	0.260
40	32	10	1000	167 546 165	167 546 175	0.450
50	40	10	1600	167 546 166	167 546 176	0.630
63	50	10	3100	167 546 167	167 546 177	1.195

d [mm]	D [mm]	H [mm]	H1 [mm]	H2 [mm]	L [mm]	L1 [mm]	L2 [mm]	L4 [mm]	L5 [mm]	L6 [mm]	M	z [mm]
16	50	57	27	12	93	77	56	25	32	45	M6	67
20	50	57	27	12	95	77	56	25	32	45	M6	67
25	58	67	30	12	109	97	65	25	39	58	M6	77
32	68	73	36	12	119	97	71	25	39	58	M6	83
40	84	90	44	15	135	128	85	45	54	74	M8	99
50	97	97	51	15	147	128	89	45	54	74	M8	105
63	124	116	64	15	168	152	101	45	66	87	M8	113



DN10/15 - 50

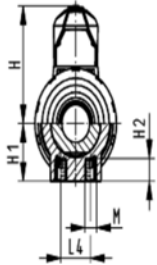
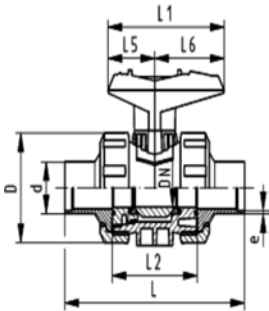

Ball valve type 546 PP-H With mounting inserts With butt fusion spigots PE100 SDR11 metric

Model:

- Material: PP-H
- For easy installation and removal
- Ball seals PTFE
- Integrated stainless steel mounting inserts
- z-dimension, valve end and union nut are not compatible with type 346

Option:

- Individual configuration of the valve (see form)
- Multifunctional module with integrated limit switches
- Pneumatic or electric actuators from +GF+

d [mm]	DN [mm]	PN	kv-value ($\Delta p=1$ bar) [l/min]	EPDM Code	FPM Code	kg								M	e [mm]
20	15	10	185	167 546 142	167 546 152	0.120								M6	1,9
25	20	10	350	167 546 143	167 546 153	0.180								M6	2,3
32	25	10	700	167 546 144	167 546 154	0.255								M6	3
40	32	10	1000	167 546 145	167 546 155	0.440								M8	3,7
50	40	10	1600	167 546 146	167 546 156	0.620								M8	4,6
63	50	10	3100	167 546 147	167 546 157	1.200								M8	5,8

d [mm]	D [mm]	H [mm]	H1 [mm]	H2 [mm]	L [mm]	L1 [mm]	L2 [mm]	L3 [mm]	L4 [mm]	L5 [mm]	L6 [mm]	M	e [mm]
20	50	57	27	12	130	77	56	130	25	32	45	M6	1,9
25	58	67	30	12	143	97	65	150	25	39	58	M6	2,3
32	68	73	36	12	150	97	71	160	25	39	58	M6	3
40	84	90	44	15	171	128	85	180	45	54	74	M8	3,7
50	97	97	51	15	191	128	89	200	45	54	74	M8	4,6
63	124	116	64	15	220	152	101	230	45	66	87	M8	5,8



DN10/15 - 50

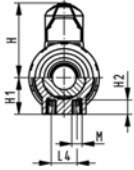
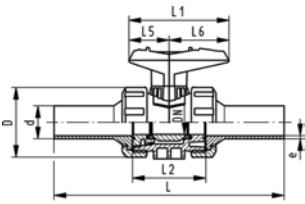



Ball valve type 546 PP-H With mounting inserts With butt fusion spigots long PE100 SDR11 metric



Model:

- Material: PP-H
- For easy installation and removal
- Ball seals PTFE
- Integrated stainless steel mounting inserts
- Image and drawing DN65-100 please see **"New product ball valve DN65-100"**
- z-dimension, valve end and union nut are **not compatible** with type 346 (DN10/15-50) resp. type 370 (DN65-100)

Option:

- Individual configuration of the valve (see form)
- Multifunctional module with integrated limit switches
- Pneumatic or electric actuators from +GF+

d [mm]	DN [mm]	PN	kv-value ($\Delta p=1$ bar) [l/min]	EPDM Code	FPM Code	kg
20	15	10	185	167 546 282	167 546 292	0.130
25	20	10	350	167 546 283	167 546 293	0.195
32	25	10	700	167 546 284	167 546 294	0.280
40	32	10	1000	167 546 285	167 546 295	0.485
50	40	10	1600	167 546 286	167 546 296	0.695
63	50	10	3100	167 546 287	167 546 297	1.320
 75	65	10	5000	167 546 288	167 546 298	3.900
 90	80	10	7000	167 546 289	167 546 299	5.900
 110	100	10	11000	167 546 290	167 546 300	9.300

d [mm]	D [mm]	H [mm]	H1 [mm]	H2 [mm]	L [mm]	L1 [mm]	L2 [mm]	L4 [mm]	L5 [mm]	L6 [mm]	M	e [mm]
20	50	57	27	12	193	77	56	25	32	45	M6	2,3
25	58	67	30	12	216	97	65	25	39	58	M6	2,3
32	68	73	36	12	223	97	71	25	39	58	M6	3
40	84	90	44	15	249	128	85	45	54	74	M8	3,7
50	97	97	51	15	271	128	89	45	54	74	M8	4,6
63	124	116	64	15	321	152	101	45	66	87	M8	5,8
 75	166	149	85	15	386	270	136	70	64	206	M8	6.8
 90	200	161	105	15	421	270	141	70	64	206	M8	8.2
 110	238	178	123	22	484	320	164	120	64	256	M12	10



DN10/15 - 50

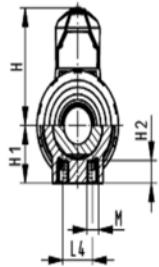
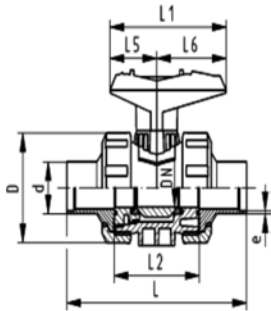

Ball valve type 546 PP-H With mounting inserts With butt fusion spigots PE100 SDR17.6 metric

Model:

- Material: PP-H
- For easy installation and removal
- Ball seals PTFE
- Integrated stainless steel mounting inserts
- z-dimension, valve end and union nut are not compatible with type 346

Option:

- Individual configuration of the valve (see form)
- Multifunctional module with integrated limit switches
- Pneumatic or electric actuators from +GF+

d [mm]	DN [mm]	PN	kv-value ($\Delta p=1$ bar) [l/min]	EPDM Code	FPM Code	kg
50	40	6	1600	167 546 126	167 546 136	0.620
63	50	6	3100	167 546 127	167 546 137	1.200

d [mm]	D [mm]	H [mm]	H1 [mm]	H2 [mm]	L [mm]	L1 [mm]	L2 [mm]	L4 [mm]	L5 [mm]	L6 [mm]	M	e [mm]
50	97	97	51	15	191	128	89	45	54	74	M8	2,9
63	124	116	64	15	220	152	101	45	66	87	M8	3,6



DN10/15 - 50

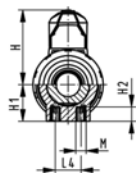
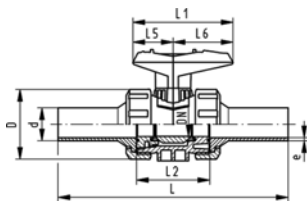

PROGEF Standard Ball valve type 546 With mounting inserts With butt fusion spigots long PE100 SDR17,6 metric

Model:

- Material: PP-H
- For easy installation and removal
- Ball seals PTFE
- Integrated stainless steel mounting inserts
- Image and drawing DN65-100 please see "New product ball valve DN65-100"
- z-dimension, valve end and union nut are **not compatible** with type 346 (DN10/15-50) resp. type 370 (DN65-100)

Option:

- Individual configuration of the valve (see form)
- Multifunctional module with integrated limit switches
- Pneumatic or electric actuators from +GF+

d [mm]	DN [mm]	PN	kv-value ($\Delta p=1$ bar) [l/min]	EPDM Code	FPM Code	kg
75	65	10	5000	167 546 308	167 546 318	3.900
90	80	10	7000	167 546 309	167 546 319	5.800
110	100	10	11000	167 546 310	167 546 320	9.200

d [mm]	D [mm]	H [mm]	H1 [mm]	H2 [mm]	L [mm]	L1 [mm]	L2 [mm]	L4 [mm]	L5 [mm]	L6 [mm]	M	e [mm]
75	166	149	85	15	386	270	136	70	64	206	8	4.3
90	200	161	105	15	421	270	141	70	64	206	8	5.1
110	238	178	123	22	484	320	164	120	64	256	12	6.3



PROGEF Standard Ball valve type 546 With mounting inserts With backing flanges PP-st metric

Model:

- Material: PP-H
- For easy installation and removal
- Ball seals PTFE
- Integrated stainless steel mounting inserts
- Image and drawing DN65-100 please see **"New product ball valve DN65-100"**
- z-dimension, valve end and union nut are **not compatible** with type 346 (DN10/15-50) resp. type 370 (DN65-100)
- Overall length according to EN 558
- Connecting dimension: ISO 7005, EN 1092, BS 4504, DIN 2501

Option:

- Individual configuration of the valve (see form)
- Multifunctional module with integrated limit switches
- Pneumatic or electric actuators from +GF+

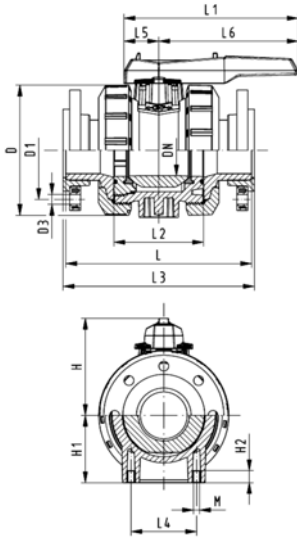

d [mm]	DN [mm]	PN	kv-value ($\Delta p=1$ bar) [l/min]	EPDM Code	FPM Code	kg	
75	65	10	5000	167 546 808	167 546 818	4.300	
90	80	10	7000	167 546 809	167 546 819	6.400	
110	100	10	11000	167 546 810	167 546 820	10.000	

d [mm]	D [mm]	D1 [mm]	D3 [mm]	L [mm]	L1 [mm]	L2 [mm]	L3 [mm]	L4 [mm]	L5 [mm]	L6 [mm]	H [mm]	H1 [mm]	M	
75	166	145	18	280	270	136	290	70	64	206	149	85	8	
90	200	160	18	296	270	141	310	70	64	206	161	105	8	
110	238	180	18	336	320	164	350	120	64	256	178	123	12	



DN10/15 - 50

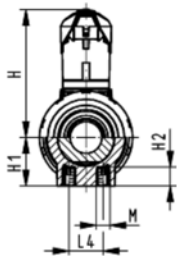
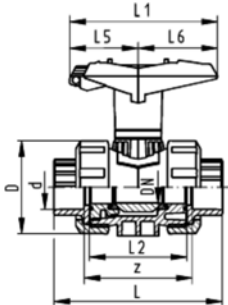

Ball valve type 546 PP-H With lockable handle With fusion sockets metric

Model:

- Material: PP-H
- Image and drawing DN65-100 please see "**New product ball valve DN65-100**"
- For easy installation and removal
- z-dimension, valve end and union nut are **not compatible** with type 346 (DN10/15-50) resp. type 370 (DN65-100)
- Ball seals PTFE
- Integrated stainless steel mounting inserts
- Lockable hand lever with ratchet settings

Option:

- Individual configuration of the valve (see form)
- Multifunctional module with integrated limit switches
- Pneumatic or electric actuators from +GF+

d [mm]	DN [mm]	PN	kv-value ($\Delta p=1$ bar) [l/min]	EPDM Code	FPM Code	kg
16	10	10	71	167 546 421	167 546 431	0.125
20	15	10	185	167 546 422	167 546 432	0.125
25	20	10	350	167 546 423	167 546 433	0.195
32	25	10	700	167 546 424	167 546 434	0.270
40	32	10	1000	167 546 425	167 546 435	0.465
50	40	10	1600	167 546 426	167 546 436	0.635
63	50	10	3100	167 546 427	167 546 437	1.175
75	65	10	5000	167 546 428	167 546 438	4.000
90	80	10	7000	167 546 429	167 546 439	5.900
110	100	10	11000	167 546 430	167 546 440	9.100

d [mm]	D [mm]	H [mm]	H1 [mm]	H2 [mm]	L [mm]	L1 [mm]	L2 [mm]	L4 [mm]	L5 [mm]	L6 [mm]	M	z [mm]
16	50	79	27	12	93	77	56	25	32	45	M6	67
20	50	79	27	12	95	77	56	25	32	45	M6	66
25	58	88	30	12	109	97	65	25	39	58	M6	77
32	68	94	36	12	119	97	71	25	39	58	M6	83
40	84	113	44	15	135	128	85	45	54	74	M8	99
50	97	119	51	15	147	128	89	45	54	74	M8	105
63	124	141	64	15	168	152	101	45	66	87	M8	117
75	166	224	85	15	233	270	136	70	64	206	M8	167
90	200	235	105	15	254	270	141	70	64	206	M8	180
110	238	245	123	22	301	320	164	120	64	256	M12	215



Ball valve type 546 PP-H With lockable handle With butt fusion spigots IR-Plus SDR11 metric



Model:

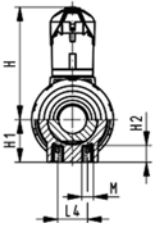
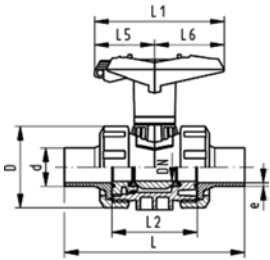

- Material: PP-H
- Image and drawing DN65-100 please see "**New product ball valve DN65-100**"
- For easy installation and removal
- z-dimension, valve end and union nut are **not compatible** with type 346 (DN10/15-50) resp. type 370 (DN65-100)
- Ball seals PTFE
- Integrated stainless steel mounting inserts
- Lockable hand lever with ratchet settings

Option:

- Individual configuration of the valve (see form)
- Multifunctional module with integrated limit switches
- Pneumatic or electric actuators from +GF+



d [mm]	DN [mm]	PN	kv-value ($\Delta p=1$ bar) [l/min]	EPDM Code	FPM Code	kg	
20	15	10	185	167 546 462	167 546 472	0.130	
25	20	10	350	167 546 463	167 546 473	0.195	
32	25	10	700	167 546 464	167 546 474	0.270	
40	32	10	1000	167 546 465	167 546 475	0.465	
50	40	10	1600	167 546 466	167 546 476	0.645	
63	50	10	3100	167 546 467	167 546 477	1.230	
 75	65	10	5000	167 546 468	167 546 478	4.100	
 90	80	10	7000	167 546 469	167 546 479	5.900	
 110	100	10	11000	167 546 470	167 546 480	9.000	

d [mm]	D [mm]	H [mm]	H1 [mm]	H2 [mm]	L [mm]	L1 [mm]	L2 [mm]	L4 [mm]	L5 [mm]	L6 [mm]	M	e [mm]	
20	50	79	27	12	130	87	56	25	42	45	M6	1,9	
25	58	88	30	12	143	108	65	25	50	58	M6	2,3	
32	68	94	36	12	150	108	71	25	50	58	M6	3	
40	84	113	44	15	171	140	85	45	66	75	M8	3,7	
50	97	119	51	15	191	140	89	45	66	75	M8	4,6	
63	124	141	64	15	220	165	101	45	78	87	M8	5,8	
 75	166	149	85	15	266	270	136	70	64	206	M8	8.2	
 90	200	161	105	15	264	270	141	70	64	206	M8	9.9	
 110	238	178	123	22	301	320	164	120	64	256	M12	12	

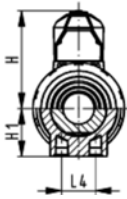
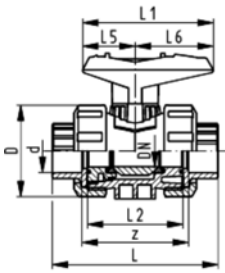

Ball valve type 546 PP-H With fusion sockets metric

Model:

- Material: PP-H
- Image and drawing DN65-100 please see **"New product ball valve DN65-100"**
- For easy installation and removal
- z-dimension, valve end and union nut are **not compatible** with type 346 (DN10/15-50) resp. type 370 (DN65-100)
- Ball seals PTFE
- Without mounting inserts

Option:

- Individual configuration of the valve (see form)
- Multifunctional module with integrated limit switches
- Pneumatic or electric actuators from +GF+

d [mm]	DN [mm]	PN	kv-value ($\Delta p=1$ bar) [l/min]	EPDM Code	FPM Code	kg	
16	10	10	71	167 546 001	167 546 011	0.115	
20	15	10	185	167 546 002	167 546 012	0.115	
25	20	10	350	167 546 003	167 546 013	0.180	
32	25	10	700	167 546 004	167 546 014	0.255	
40	32	10	1000	167 546 005	167 546 015	0.440	
50	40	10	1600	167 546 006	167 546 016	0.610	
63	50	10	3100	167 546 007	167 546 017	1.145	
75	65	10	5000	167 546 008	167 546 018	3.700	
90	80	10	7000	167 546 009	167 546 019	5.500	
110	100	10	11000	167 546 010	167 546 020	8.700	

d [mm]	D [mm]	H [mm]	H1 [mm]	L [mm]	L1 [mm]	L2 [mm]	L4 [mm]	L5 [mm]	L6 [mm]	z [mm]	
16	50	57	27	93	77	56	25	32	45	67	
20	50	57	27	95	77	56	25	32	45	66	
25	58	67	30	109	97	65	25	39	58	77	
32	68	73	36	119	97	71	25	39	58	83	
40	84	90	44	135	128	85	45	54	74	99	
50	97	97	51	147	128	89	45	54	74	105	
63	124	116	64	168	152	101	45	66	87	117	
75	166	149	85	233	270	136	70	64	206	167	
90	200	161	105	254	270	141	70	64	206	180	
110	238	178	123	301	320	164	120	64	256	215	

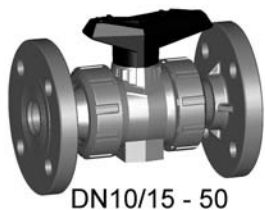

DN10/15 - 50

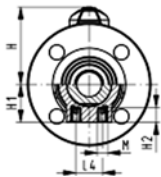
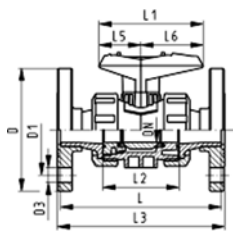

PROGEF Standard Ball valve type 546 With mounting inserts With fixed flanges PP-H serrated metric

Model:

- Material: PP-H
- For easy installation and removal
- Ball seals PTFE
- Integrated stainless steel mounting inserts
- z-dimension, valve end and union nut are not compatible with type 346
- Overall length EN 558
- Connecting dimensions: ISO 7005 / EN 1092 / DIN 2501 PN10 / BS4504

Option:

- Individual configuration of the valve (see form)
- Multifunctional module with integrated limit switches
- Pneumatic or electric actuators from +GF+

d [mm]	DN [mm]	Inch	PN	kv-value ($\Delta p=1$ bar) [l/min]	EPDM Code	FPM Code	kg
20	15	½	10	185	167 546 182	167 546 192	0.245
25	20	¾	10	350	167 546 183	167 546 193	0.345
32	25	1	10	700	167 546 184	167 546 194	0.495
40	32	1 ¼	10	1000	167 546 185	167 546 195	0.830
50	40	1 ½	10	1600	167 546 186	167 546 196	1.100
63	50	2	10	3100	167 546 187	167 546 197	1.830

d [mm]	D [mm]	D1 [mm]	D3 [mm]	H [mm]	H1 [mm]	H2 [mm]	L [mm]	L1 [mm]	L2 [mm]	L3 [mm]	L4 [mm]	L5 [mm]	L6 [mm]	M
20	95	65	14	57	27	12	120	77	56	130	25	32	45	M6
25	105	75	14	67	30	12	140	97	65	150	25	39	58	M6
32	115	85	14	73	36	12	150	97	71	160	25	39	58	M6
40	140	100	18	90	44	15	170	128	85	180	45	54	74	M8
50	150	110	18	97	51	15	190	128	89	200	45	54	74	M8
63	165	125	18	116	64	15	220	152	101	230	45	66	87	M8

Component Parts for Flange Assembly Ball Valves Type 546

27 79 02

PROGEF Standard, Flange Adaptor Jointing face flat/serrated

d [mm]	PN	Code	kg
20	10	727 790 206	0.011
25	10	727 790 207	0.022
32	10	727 790 208	0.033
40	10	727 790 209	0.046
50	10	727 790 210	0.062
63	10	727 790 211	0.090
75	10	727 790 212	0.163
90	10	727 790 213	0.233
110	10	727 790 214	0.319

PROGEF Standard, Special Flange Adaptors, PP-H S5/SDR11 Jointing Face, combination serrated / flat metric

d [mm]	DN [mm]	FM	Code	kg
75	65	IR	727 798 512	0.243
90	80	IR	727 798 513	0.326
90	80	IR	727 798 663	0.346
110	100	IR	727 798 514	0.441
125	100	IR	727 798 515	0.520
140	125	IR	727 798 516	0.800
160	150	IR	727 798 517	0.920
180	150	IR	727 798 568	0.900
200	200	IR	727 798 519	1.670
225	200	IR	727 798 520	1.700
250	250	--	727 798 571	2.790
280	250	--	727 798 572	2.610
315	300	--	727 798 573	3.410
355	350	--	727 798 574	5.600
400	400	--	727 798 575	8.300

EPDM 48 44 07
FPM 49 44 07

**Profile Flange Gaskets metric
EPDM / FPM**



d [mm]	DN [mm]	PN	EPDM Code	FPM Code	kg
16	10	16	748 440 705	749 440 705	0.007
20	15	16	748 440 706	749 440 706	0.008
25	20	16	748 440 707	749 440 707	0.011
32	25	16	748 440 708	749 440 708	0.014
40	32	16	748 440 709	749 440 709	0.021
50	40	16	748 440 710	749 440 710	0.022
63	50	16	748 440 711	749 440 711	0.041
75	65	16	748 440 712	749 440 712	0.055
90	80	16	748 440 713	749 440 713	0.062
110	100	16	748 440 714	749 440 714	0.085
125	100	16	748 440 715	749 440 715	0.158
140	125	16	748 440 716	749 440 716	0.118
160 / 180	150	16	748 440 717	749 440 717	0.153
200	200	16	748 440 719	749 440 719	0.263
225	200	16	748 440 720	749 440 720	0.181
250	250	16	748 440 721	749 440 721	0.410
280	250	16	748 440 722	749 440 722	0.226
315	300	16	748 440 723	749 440 723	0.334
355	350	16	748 440 724	749 440 724	0.410
400	400	16	748 440 725	749 440 725	0.513

27 70 04
27 70 05

**Backing Flanges, PP-V
for Socket Systems metric**

d [mm]	Inch	DN [mm]	PN	Code	kg
20		15	16	727 700 406	0.080
25		20	16	727 700 407	0.100
32		25	16	727 700 408	0.140
40		32	16	727 700 409	0.220
50		40	16	727 700 410	0.210
63		50	16	727 700 411	0.380
75		65	16	727 700 412	0.480
90		80	16	727 700 413	0.520
110		100	16	727 700 414	0.680

27 30 10
27 40 10

**Fixed Flanges, PP-H metric
Jointing Face flat**

d [mm]	DN [mm]	Inch	PN	Code	kg
20	15	1/2	10	727 730 106	0.069
25	20	3/4	10	727 730 107	0.094
32	25	1	10	727 730 108	0.129
40	32	1 1/4	10	727 730 109	0.203
50	40	1 1/2	10	727 730 110	0.246
63	50	2	10	727 730 111	0.330

Ball valves

SYGEF® standard Ball valve type 546 PVDF With mounting inserts With butt fusion spigots metric

J



DN10/15 - 50

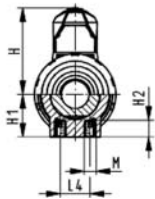
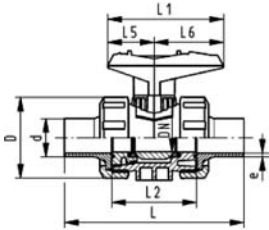

Model:

- For easy installation and removal
- z-dimension, valve end and valve nut are **not compatible** with type 346 (DN10/15-50) resp. type 370 (DN65-100)
- Ball seals PTFE
- Integrated stainless steel mounting inserts

Option:

- Individual configuration of the valve (see form)
- Multifunctional module with integrated limit switches
- Pneumatic or electric actuators from +GF+

d [mm]	DN [mm]	PN	kv-value ($\Delta p=1$ bar) [l/min]	FPM Code	kg
20	15	16	185	175 546 272	0.205
25	20	16	350	175 546 273	0.310
32	25	16	700	175 546 274	0.460
40	32	16	1000	175 546 275	0.780
50	40	16	1600	175 546 276	1.110
63	50	16	3100	175 546 277	2.150

d [mm]	D [mm]	H [mm]	H1 [mm]	H2 [mm]	L [mm]	L1 [mm]	L2 [mm]	L4 [mm]	L5 [mm]	L6 [mm]	M	e [mm]
20	50	57	27	12	130	77	56	25	32	45	M6	1,9
25	58	67	30	12	143	97	65	25	39	58	M6	1,9
32	68	73	36	12	150	97	71	25	39	58	M6	2,4
40	84	90	44	15	171	128	85	45	54	74	M8	2,4
50	97	97	51	15	191	128	89	45	54	74	M8	3
63	124	116	64	15	220	152	101	45	66	87	M8	3

PF 2 35 540



DN10/15 - 50

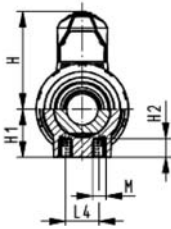
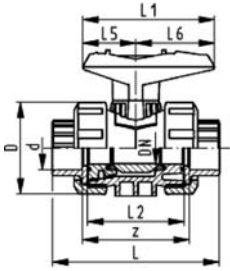

SYGEF® standard Ball valve type 546 PVDF With mounting inserts With fusion sockets metric

J

Model:

- For easy installation and removal
- z-dimension, valve end and valve nut are **not compatible** with type 346 (DN10/15-50) resp. type 370 (DN65-100)
- Ball seals PTFE
- Integrated stainless steel mounting inserts

Option:

- Individual configuration of the valve (see form)
- Multifunctional module with integrated limit switches
- Pneumatic or electric actuators from +GF+

d [mm]	DN [mm]	PN	kv-value ($\Delta p=1$ bar) [l/min]	FPM Code	kg
16	10	16	71	175 546 411	0.195
20	15	16	185	175 546 412	0.200
25	20	16	350	175 546 413	0.300
32	25	16	700	175 546 414	0.440
40	32	16	1000	175 546 415	0.760
50	40	16	1600	175 546 416	1.060
63	50	16	3100	175 546 417	2.055

d [mm]	D [mm]	H [mm]	H1 [mm]	H2 [mm]	L [mm]	L1 [mm]	L2 [mm]	L4 [mm]	L5 [mm]	L6 [mm]	M	z [mm]
16	50	79	27	12	93	77	56	25	32	45	M6	67
20	50	57	27	12	95	77	56	25	32	45	M6	66
25	58	67	30	12	109	97	65	25	39	58	M6	77
32	68	73	36	12	119	97	71	25	39	58	M6	83
40	84	90	44	15	135	128	85	45	54	74	M8	99
50	97	97	51	15	147	128	89	45	54	74	M8	105
63	124	116	64	15	168	152	101	45	66	87	M8	117

PF 2 35 540



DN10/15 - 50

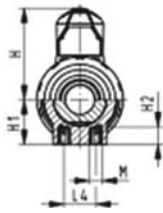
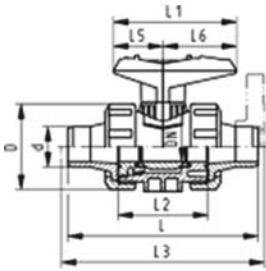

SYGEF® standard Ball valve type 546 PVDF With mounting inserts With socket fusion spigots metric

J

Model:

- For easy installation and removal
- z-dimension, valve end and valve nut are **not compatible** with type 346 (DN10/15-50) resp. type 370 (DN65-100)
- Ball seals PTFE
- Integrated stainless steel mounting inserts

Option:

- Individual configuration of the valve (see form)
- Multifunctional module with integrated limit switches
- Pneumatic or electric actuators from +GF+

d [mm]	DN [mm]	PN	kv-value ($\Delta p=1$ bar) [l/min]	FPM Code	kg
16	10	16	71	175 546 051	0.200
20	15	16	185	175 546 052	0.205
25	20	16	350	175 546 053	0.310
32	25	16	700	175 546 054	0.460
40	32	16	1000	175 546 055	0.780
50	40	16	1600	175 546 056	1.110
63	50	16	3100	175 546 057	2.150

d [mm]	D [mm]	H [mm]	H1 [mm]	H2 [mm]	L [mm]	L1 [mm]	L2 [mm]	L3 [mm]	L4 [mm]	L5 [mm]	L6 [mm]	M
16	50	57	27	12	110	77	56		25	32	45	M6
20	50	57	27	12	120	77	56	130	25	32	45	M6
25	58	67	30	12	139	97	65	150	25	39	58	M6
32	68	73	36	12	150	97	71	160	25	39	58	M6
40	84	90	44	15	170	128	85	180	45	54	74	M8
50	97	97	51	15	190	128	89	200	45	54	74	M8
63	124	116	64	15	220	152	101	230	45	66	87	M8

PF 2 35 540



DN10/15 - 50

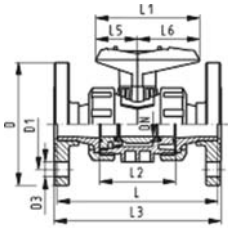

SYGEF® standard Ball valve type 546 PVDF With mounting inserts With fixed flanges PVDF serrated metric

J

Model:

- For easy installation and removal
- z-dimension, valve end and valve nut are **not compatible** with type 346 (DN10/15-50) resp. type 370 (DN65-100)
- Ball seals PTFE
- Integrated stainless steel mounting inserts
- Overall length EN 558-1

Option:

- Individual configuration of the valve (see form)
- Multifunctional module with integrated limit switches
- Pneumatic or electric actuators from +GF+

d [mm]	DN [mm]	PN	kv-value ($\Delta p=1$ bar) [l/min]	FPM Code	kg
20	15	16	185	175 546 192	0.470
25	20	16	350	175 546 193	0.650
32	25	16	700	175 546 194	0.940
40	32	16	1000	175 546 195	1.570
50	40	16	1600	175 546 196	2.070
63	50	16	3100	175 546 197	3.490

d [mm]	D [mm]	D1 [mm]	D3 [mm]	H [mm]	H1 [mm]	H2 [mm]	L [mm]	L1 [mm]	L2 [mm]	L3 [mm]	L4 [mm]	L5 [mm]	L6 [mm]	M
20	93	65	14	57	27	12	120	77	56	130	25	32	45	M6
25	103	75	14	67	30	12	140	97	65	150	25	39	58	M6
32	115	85	14	73	36	12	150	97	71	160	25	39	58	M6
40	137	100	18	90	44	15	170	128	85	180	45	54	74	M8
50	147	110	18	97	51	15	190	128	89	200	45	54	74	M8
63	162	125	18	116	64	15	220	152	101	230	45	66	87	M8

PF 2 35 540



DN10/15 - 50

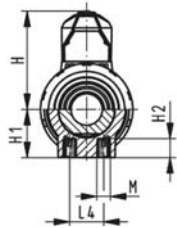
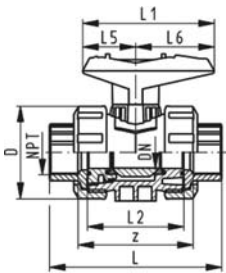

SYGEF® standard Ball valve type 546 PVDF With mounting inserts With threaded sockets NPT

J

Model:

- For easy installation and removal
- z-dimension, valve end and valve nut are **not compatible** with type 346 (DN10/15-50) resp. type 370 (DN65-100)
- Ball seals PTFE
- Integrated stainless steel mounting inserts

Option:

- Individual configuration of the valve (see form)
- Multifunctional module with integrated limit switches
- Pneumatic or electric actuators from +GF+

NPT [inch]	DN [mm]	PN	kv-value ($\Delta p=1$ bar) [l/min]	FPM Code	kg
3/8	10	10	71	175 546 331	0.205
1/2	15	10	185	175 546 332	0.220
3/4	20	10	350	175 546 333	0.325
1	25	10	700	175 546 334	0.490
1 1/4	32	10	1000	175 546 335	0.820
1 1/2	40	10	1600	175 546 336	1.135
2	50	10	3100	175 546 337	2.150

NPT [inch]	D [mm]	H [mm]	H1 [mm]	H2 [mm]	L [mm]	L1 [mm]	L2 [mm]	L4 [mm]	L5 [mm]	L6 [mm]	M	z [mm]
3/8	50	57	27	12	96	77	56	25	32	45	M6	69
1/2	50	57	27	12	99	77	56	25	32	45	M6	64
3/4	58	67	30	12	111	97	65	25	39	58	M6	76
1	68	73	36	12	127	97	71	25	39	58	M6	83
1 1/4	84	90	44	15	146	128	85	45	54	74	M8	101
1 1/2	97	97	51	15	157	128	89	45	54	74	M8	111
2	124	116	64	15	183	152	101	45	66	87	M8	135

PF 2 35 540



DN10/15 - 50

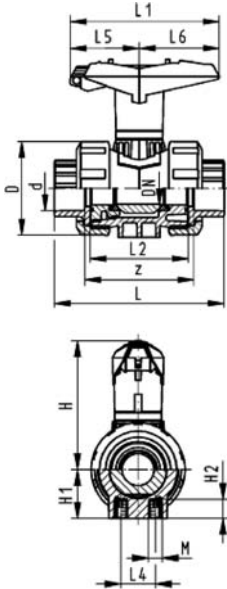

SYGEF® standard Ball valve type 546 PVDF With lockable handle With fusion sockets metric

J

Model:

- For easy installation and removal
- z-dimension, valve end and valve nut are **not compatible** with type 346 (DN10/15-50) resp. type 370 (DN65-100)
- Ball seals PTFE
- Integrated stainless steel mounting inserts
- Lockable hand lever with ratchet settings

Option:

- Individual configuration of the valve (see form)
- Multifunctional module with integrated limit switches
- Pneumatic or electric actuators from +GF+

d [mm]	DN [mm]	PN	kv-value ($\Delta p=1$ bar) [l/min]	FPM Code	kg
16	10	16	71	175 546 431	0.205
20	15	16	185	175 546 432	0.210
25	20	16	350	175 546 433	0.315
32	25	16	700	175 546 434	0.455
40	32	16	1000	175 546 435	0.785
50	40	16	1600	175 546 436	1.085
63	50	16	3100	175 546 437	2.085

d [mm]	D [mm]	H [mm]	H1 [mm]	H2 [mm]	L [mm]	L1 [mm]	L2 [mm]	L4 [mm]	L5 [mm]	L6 [mm]	M	z [mm]
16	50	79	27	12	93	77	56	25	32	45	M6	67
20	50	79	27	12	95	77	56	25	32	45	M6	66
25	58	88	30	12	109	97	65	25	39	58	M6	77
32	68	94	36	12	119	97	71	25	39	58	M6	83
40	84	113	44	15	135	128	85	45	54	74	M8	99
50	97	119	51	15	147	128	89	45	54	74	M8	105
63	124	141	64	15	168	152	101	45	66	87	M8	117

PF 2 35 540